

**VILLAGE OF DOWNERS GROVE
REPORT FOR THE VILLAGE COUNCIL MEETING
OCTOBER 9, 2012 AGENDA**

SUBJECT:	TYPE:	SUBMITTED BY:
Proposed Parking and Traffic Changes: Belmont Road Underpass, Downers Grove North High School, Village Parking Deck	Resolution ✓ Ordinance Motion Discussion Only	Nan Newlon, P.E. Director of Public Works

SYNOPSIS

An ordinance has been prepared to amend various sections of the Municipal Code concerning a series of parking and traffic changes in three areas resulting from modifications from construction projects at the Belmont Road Underpass and Downers Grove North High School, and from implementation of the Village’s 2011 Downtown Parking Study.

STRATEGIC PLAN ALIGNMENT

The goals for 2011-2018 identified *Top Quality Infrastructure*.

FISCAL IMPACT

N/A

RECOMMENDATION

Approval on the October 16, 2012 Active Agenda.

BACKGROUND

Belmont Road Parking and Operational Changes

The Belmont Road Underpass project was initiated over two and a half years ago and is substantially complete. Staff reviewed the operational and traffic changes that are a result of this project, and is presenting the following recommended parking and traffic changes:

- Install All-Way STOP control at Warren Ave/West Loop Ramp intersection;
- Install 2-Way STOP control at Burlington Ave/East Loop Ramp intersection, with Eastbound traffic uncontrolled;
- Remove the 12-Hour parking meter zone along the south side of Warren Avenue, between Belmont Road and Pershing Avenue and include these parking spaces with the existing Village Commuter Lot G;
- Designate an area on the south side of Burlington Avenue, immediately west of the West Loop Ramp intersection for the Grove Shuttle evening passenger pick-up operation;
- Install turn restrictions from Village Lot J, prohibiting left turns to westbound Haddow Avenue;
- Install turn restrictions from northbound Belmont Road onto West Loop Ramp;
- Install turn restrictions from southbound Belmont Road onto East Loop Ramp; and
- Replace the 12-Hour parking meter zone along the south side of Burlington Ave, between Walnut and Chase Ave with daily fee parking.

These changes will increase driver safety, streamline commuter parking operations by removing parking meters and replacing them with daily fee spaces, and enhance service to Grove Shuttle riders by moving the evening pick-up location to the north platform. A map showing the locations of the changes is attached.

North High School Parking and Traffic Changes

Site and building improvements at Downers Grove North High School are nearing completion. As a result of this work, minor changes to the Village Code related to parking and traffic operations in the area of the school are recommended. These include:

- As a result of moving the bus loading and unloading operation to an off-street parking lot, eliminate the Code designated Bus Loading Zone along the east side of Prince Street, south of Grant Street;
- As a result of moving the bus loading and unloading from Prince and Grant streets, eliminate the Code designated Road Closure of Prince Street and Grant Street, during the 3:00 – 4:00 PM hour;
- To enhance pedestrian safety and facilitate the sharing of play fields and parking areas between the two schools designate a new mid-block School Crossing on Saratoga Avenue, north of the west parking lot, with mid-block Pedestrian Crossing and mid-block street signage; and
- Update the Code to reflect the already existing All-Way STOP control at the Prince Street and Grant Street intersection.

Parking Deck Parking Changes

Staff has reviewed recommendations presented in the Downtown Parking Study as well as those discussed by the Village's Parking Operations Group with respect to the parking on the top level of the deck and to commuter motorcycle parking in the downtown.

Levels 3 and 4 of the deck are available to daily fee users beginning at 5:00 AM on a first-come, first-serve basis and were found to be up to 100% occupied when parking counts were conducted for the Study. Level 5 of the deck has been operated as a combination of permit (Lot S) and daily fee parking; however, parking was prohibited in the daily fee spaces before 8:00 AM. This regulation, along with a strong demand for parking for express trains around 8:00 AM, resulted in frustration by parkers and enforcement problems. Parking counts from the top level of the deck also showed that it was not being used to its fullest capacity.

The Parking Operations Group reviewed the operation of the top level of the deck and recommended that daily fee parking on this level be expanded and simplified. The specific changes include:

- Allow daily fee parking on Level 5 of the deck beginning at 5:00 AM, consistent with Levels 3 and 4.
- Reduce the number of dedicated Lot S permit spaces from 100 to 40 spaces to reflect the current number of Lot S permit holders;
- Eliminate Lot S permits through attrition. Move Lot S permit holders to other lots as space becomes available and eventually eliminate permit parking on Level 5 of the deck.

The east side of Forest Avenue south of Burlington Avenue was striped and signed to accommodate approximately 7 commuter motorcycle parking spaces. This area was being used for all-day parking mostly during favorable weather, and was unavailable for other downtown parking uses. The Downtown Parking Study identified a shortage of short-term parking during peak times in this area of the Downtown. To expand parking, staff has identified and designated covered motorcycle parking within the parking deck, which is more appropriate for all-day parking. This change was made without displacing other parking users in the deck and allows for three (3) additional three-hour public parking spaces to be designated on Forest Avenue. The specific recommended Code changes include:

- Designate seventeen (17) motorcycle spaces in the Parking Deck; and
- Convert seven (7) motorcycle spaces on Forest Ave to 3-Hour spaces.

These items were presented at the September 12, 2012 Transportation and Parking Commission meeting and the Commission voted unanimously to approve staff's proposed parking and traffic changes for each of the three affected areas.

ATTACHMENTS

Excerpts of Meeting Minutes – TAP Commission meeting September 12, 2012.

Exhibits – Belmont Rd, Parking Deck, North High School

Ordinance

Parking & Traffic

ORDINANCE NO. _____

AN ORDINANCE AMENDING PARKING AND TRAFFIC PROVISIONS IN MUNICIPAL LOTS, AT THE BELMONT/STATION UNDERPASS AND AT LOCAL HIGH SCHOOLS

BE IT ORDAINED by the Village Council of the Village of Downers Grove in DuPage County, Illinois, as follows: (Additions are indicated by shading/underline; deletions by ~~strikeout~~):

Section 1. That Section 14.4.1. is hereby amended to read as follows:

14.4.1. Temporary Road Closures - School Zones.

The following roadways shall be closed on a temporary basis:

a. School Zones. To coincide with the afternoon dismissal of high school students, as described below:

~~*Grant Street*, Saratoga Avenue to Prince Street, shall be closed to through traffic from 20 minutes before and 40 minutes after high school dismissal, Mondays through Fridays, during the school year and on days when school is in session, but allow the passage of local traffic such that residents are permitted access to their own properties.~~

Lincoln Avenue, eastbound, from Fairview Avenue to Cumnor Road. Provided, this restriction shall only apply on school days between the hours of 8:00 a.m. to 9:00 a.m. and 2:30 p.m. to 3:30 p.m.

~~*Prince Street*, Lincoln Avenue to Sherman Street (South), shall be closed to through traffic from 20 minutes before and 40 minutes after high school dismissal, Mondays through Fridays, during the school year and on days when school is in session, but allow the passage of local traffic such that residents are permitted access to their own properties.~~

Section 2. That Section 14.52.03. is hereby amended to read as follows:

14.52.03. Restrictions on movements of vehicles from and onto Haddow Avenue from Parking Lot "J".

~~_____ (a) It shall be unlawful for any person driving or operating any automobile, truck or other vehicle;~~

(a) in a northerly direction on Fairview Avenue to turn such vehicle left so as to proceed westerly into Parking Lot I, as designated in Section 14.85.9 Northbound from Lot "J" to turn such vehicle left so as to proceed westerly along Haddow Avenue. (Ord. No. 2546, § 1; Ord No. 2655, § 2; Ord. No. 3118, § 3; Ord. No. 3127, § 2.)

Section 3. That Section 14.52.05. is hereby amended to read as follows:

14.52.05. Restrictions on movements of vehicles from Belmont Road.

It shall be unlawful for any person driving or operating any automobile, truck or other vehicle in a northerly direction on Belmont Road to turn such vehicle left so as to proceed westerly ~~into~~onto West Loop Ramp thence onto Burlington Avenue. (Ord. No. 3118, § 6.)

Section 4. That Section 14.52.13. is hereby amended to read as follows:

14.52.13. Restrictions on movements of vehicles from the North High School East Parking Lot located between Main Street and Highland Avenue.

Parking & Traffic

It shall be unlawful for any person driving or operating any automobile, truck or other vehicle:

Reserved.

~~_____ (a) To exit eastbound from the parking lot access drive at Main Street to turn such vehicle left so as to proceed northerly along Main Street.~~

~~_____ (b) To exit westbound from the parking lot access drive at Forest Street.~~

Section 5. That Section 14.68. is hereby amended to read as follows:

14.68. Crossing Main Street at crosswalks required between Burlington Avenue and Curtiss Street.

No pedestrian shall cross Main Street in an easterly or westerly direction ~~on Main Street,~~ between Burlington Avenue and Curtiss Street, except at the designated mid-block ~~crosswalks on Burlington Avenue, Curtiss Street and at a point two hundred seven feet south of the property line of Burlington Avenue.~~ (Ord. No. 689, § 1; Ord. No. 2745, § 28.)

Section 6. That Section 14.52.22. is hereby amended to read as follows:

14.52.22. Restrictions on movements of vehicles from Main Street onto Maple Avenue from 6-8 a.m. and 4-7 p.m., Monday through Friday.

(a) It shall be unlawful for any person driving or operating any automobile, truck or other vehicle proceeding northbound on Main Street at Maple Avenue to turn such vehicle left from the left lane so as to proceed westerly on Maple Avenue between the hours of 6:00 a.m. and 8:00 a.m. and also 4:00 p.m. and ~~6~~7:00 p.m, Monday through Friday.

(b) It shall be unlawful for any person driving or operating any automobile, truck or other vehicle proceeding northbound on Main Street at Maple Avenue in the right lane to proceed straight through in a northerly direction. The northbound right lane on Main Street approaching Maple Avenue shall be a designated exclusive right turn lane only permitting right turns in an easterly direction on Maple Avenue.

Section 7. That Section 14.71. is hereby amended to read as follows:

14.71. School Crosswalks designated.

The crosswalks within the Village designated hereby as "school crossings" are as follows:
Belle Aire Lane. Across Belle Aire Lane on the south side of Drove Avenue.
Belmont Road. Across Belmont Road on the south side of Prairie Avenue.
Bending Oaks Place and Bending Oaks Court. Across Bending Oaks Place and Bending Oaks Court on the north and south sides of Elmore Avenue.
Blodgett Avenue. Across Blodgett Avenue on the north side of Hill Street.
Blodgett Avenue. Across Blodgett Avenue on the north side of Sixtieth Street extended west.
Blodgett Avenue. Across Blodgett Avenue on the north side of Sixty-first Street extended west.
Chicago Avenue. Across Chicago Avenue on the west side of Oakwood Avenue.
Chicago Avenue. Across Chicago Avenue on the east side of Douglas Road.
Claremont Drive. Across Claremont Drive on the east side of Fairmount Avenue.
Douglas Road. Across Douglas Road on the south side of Gierz Street.
Douglas Road. Across Douglas Road on the north and south of its intersection with Prairie Avenue.
Downers Drive. Across Downers Drive on the south side of Herbert Street.

Parking & Traffic

Dunham Road. Across Dunham Road on the north side of Jefferson Avenue.

Dunham Road. Across Dunham Road on the north side of Palmer Street.

Dunham Road. Across Dunham Road on the south side of Sixty-third Street.

Dunham Road. Across Dunham Road on the north side of Norfolk Street.

Fairmount Avenue. Across Fairmount Avenue at a point one hundred thirty-seven feet north of Parkview Drive.

Fairmount Avenue. Across Fairmount Avenue at a point two hundred sixty-five feet south of the south line of Sixty-eighth Street.

Fairview Avenue. Across Fairview Avenue on the north side of Fifty-ninth Street.

Fairview Avenue. Across Fairview Avenue at a point one hundred forty nine feet south of the south line of Blackburn Avenue.

Fairview Avenue. Across Fairview Avenue on the north side of Hill Street extended east.

Fairview Avenue. Across Fairview Avenue from the north side of Lincoln Avenue west of Fairview Avenue to the south side of Lincoln Avenue east of Fairview Avenue.

Fairview Avenue. Across Fairview Avenue on the north side of Prairie Avenue extended east.

Fairview Avenue. Across Fairview Avenue on the north side of 56th Street extended west.

Franklin Street. Across Franklin Street on the east side of Main Street.

Grand Avenue. Across Grand Avenue on the north side of Hill Street.

Grand Avenue. Across Grand Avenue on the south side of Hill Street.

Grant Street. Across Grant Street to the east and west of its intersection with Middaugh Avenue.

Grant Street. Across Grant Street to the east and west of its intersection with Oakwood Avenue.

Grant Street. Across Grant Street on the east side of Seeley Avenue.

Grant Street. Across Grant Street on the east side of Main Street.

Haddow Avenue. Across Haddow Avenue on the east side of Puffer Road.

Haddow Avenue. Across Haddow Avenue on the east side of Edward Avenue.

Highland Avenue. Across Highland Avenue on the north side of Franklin Street.

Highland Avenue. Across Highland Avenue on the north side of Prairie Avenue.

Indianapolis Avenue. Across Indianapolis Avenue, east of Florence Avenue.

Jefferson Avenue. Across Jefferson Avenue on the west side of Hillcrest Road extended south.

Lincoln Avenue. Across Lincoln Avenue at a point one hundred six feet west of the centerline of Florence Avenue.

Lincoln Avenue. Across Lincoln Avenue at a point ninety-four feet east of the centerline of Florence Avenue.

Main Street. Across Main Street on the south side of Fifty-Ninth Street.

Main Street. Across Main Street on the north and south sides of Franklin Street.

Main Street. Across Main Street on the north and south of its intersection with Grant Street.

Main Street. Across Main Street on the north and south of Prairie Avenue.

Main Street. Across Main Street on the south side of Thirty-Ninth Street.

Main Street. Across Main Street on the north and south sides of Ogden Avenue.

Maple Avenue. Across Maple Avenue on the west side of Dunham Road.

Maple Avenue. Across Maple Avenue on the west side of Elmwood Avenue.

Norfolk Street. Across Norfolk Street on the west side of Barrett Street extended south.

Norfolk Street. Across Norfolk Street on the east side of Powell Street.

Oakwood Ave. Across Oakwood Avenue on the north and south of its intersection with Grant Street.

Ogden Avenue. Across Ogden Avenue on the west side of Saratoga Avenue.

Parking & Traffic

- Palmer Street.* Across Palmer Street on the west side of Saratoga Avenue.
- Powell Street.* Across Powell Street on the north side of Palmer Street.
- Powell Street.* Across Powell Street on the south side of Norfolk Street.
- Prairie Avenue.* Across Prairie Avenue on the east side of Belmont Road.
- Prairie Avenue.* Across Prairie Avenue on the east and west of its intersection with Douglas Road.
- Prairie Avenue.* Across Prairie Avenue on the west side of Highland Avenue.
- Prairie Avenue.* Across Prairie Avenue on the east and west sides of Main Street.
- Prairie Avenue.* Across Prairie Avenue on the west side of Oakwood Avenue.
- Puffer Road.* Across Puffer Road on the south side of Hadow Avenue.
- Saratoga Avenue.* Across Saratoga Avenue on the north and south sides of Ogden Avenue.
- Saratoga Avenue.* Across Saratoga Avenue, midblock, on the north side of Grant Street.
- Seeley Avenue.* Across Seeley Avenue on the north side of Grant Street.
- Stonewall Avenue.* Across Stonewall Avenue on the south side of Sixty-Second Street extended west.
- Summit Street.* Across Lyman Avenue on the south side of Summit Street.
- Summit Street.* Across Park Avenue on the south side of Summit Street.
- Summit Street.* Across Fairmount Avenue on the south side of Summit Street.
- Summit Street.* Across Benton Avenue on the south side of Summit Street.
- Summit Street.* Across Blodgett Avenue on the south side of Summit Street.
- Venard Road.* Across Venard Road at 39th Street.
- Washington Street.* Across Washington Street on the south side of Franklin Street.
- Washington Street.* Across Washington Street on the north side of Randall Street.
- Washington Street.* Across Washington Street on the south side of 39th Street.
- 39th Street.* Across 39th Street on the west side of Glendenning Road.
- 55th Street.* Across 55th Street on the east side of Dunham Road.
- 55th Street.* Across 55th Street on the east side of Fairmount Avenue.
- 59th Street.* Across 59th Street on the west side of Blodgett Avenue extended north.
- 59th Street.* Across 59th Street on the east side of Fairmount Avenue extended south.
- 59th Street.* Across 59th Street on the west side of Fairview Avenue.
- 63rd Street.* Across 63rd Street on the east side of Fairmount Avenue.
- 68th Street.* Across 68th Street on the east side of Fairmount Avenue.
- 68th Street.* Across 68th Street on the west side of Briargate Drive. (Ord. No. 743, § 4; Ord. No. 763; Ord. No. 769, § 1; Ord. No. 1176, § 1; Ord. No. 1602, § 1; Ord. No. 1877, § 3; Ord. No. 1895, § 3; Ord. No. 1907, §§ 3, 4; Ord. No. 1939, § 5; Ord. No. 1965, §§ 4, 5; Ord. No. 2004, § 3; Ord. No. 2125, § 2; Ord. No. 2144, § 2; Ord. No. 2308, § 2; Ord. No. 2344, §§ 2, 3; Ord. No. 2474, § 2; Ord. No. 2514, § 1; Ord. No. 2548, §§ 1, 3; Ord. No. 2657, § 2; Ord. No. 2690, § 2; Ord. No. 2807, § 1; Ord. No. 2851, § 2; Ord. No. 2880, § 2; Ord. No. 3084, § 2; Ord. No. 3118, § 8.)

Section 8. That Section 14.80 is hereby amended to read as follows:

14.80 Isolated stop signs.

There shall be erected in conspicuous places as hereinafter designated, signs lettered with the word "Stop", which signs shall be so located as to direct vehicular traffic on the specified streets to come to a full stop before proceeding into or across the intersecting streets:

Aldrich Place. At the southwest corner of the intersection of Aldrich Place and Woodward Avenue, to direct vehicular traffic proceeding easterly on Aldrich Place to come to a full stop before proceeding across or into Woodward Avenue.

Applegate Avenue. At the northeast corner of the intersection of Applegate Avenue and Old Main Street, to direct vehicular traffic proceeding westerly on Applegate Avenue to come to

Parking & Traffic

a full stop before proceeding across or into Old Main Street.

Barneswood Drive. At the northeast corner of the intersection of Barneswood Drive and Venard Road, regulating westbound traffic on Barneswood Drive.

Barrett Street. At the northwest corner of the intersection of Barrett Street and Norfolk Street to direct traffic proceeding southerly on Barrett Street to come to a full stop before proceeding across or into Norfolk Street.

Barrett Street. At the northwest and southeast corners of the intersection of Barrett Street and 71st Street, to direct vehicular traffic proceeding southerly and northerly on Barrett Street to come to a full stop before proceeding across or into 71st Street.

Belden Avenue. At the northwest corner of the intersection of Belden Avenue and Maple Avenue, to direct vehicular traffic proceeding southerly on Belden Avenue to come to a full stop before proceeding across or into Maple Avenue.

Benton Avenue. At the southeast corner of the intersection of Benton Avenue and Maple Avenue, to direct vehicular traffic proceeding northerly on Benton Avenue to come to a full stop before proceeding across or into Maple Avenue.

Birch Avenue. At the northeast corner of the intersection of Birch Avenue and Washington Street, to direct vehicular traffic proceeding westerly on Birch Avenue to come to a full stop before proceeding across or into Washington Street.

Blackburn Avenue. At the southwest corner of the intersection of Blackburn Avenue and Fairview Avenue, to direct vehicular traffic proceeding easterly on Blackburn Avenue to come to a full stop before proceeding across or into Fairview Avenue.

Blackburn Avenue. At the northwest corner of the intersection of Blackburn Avenue and Claremont Drive, to direct traffic proceeding southerly on Blackburn Avenue to come to a full stop before proceeding across or into Claremont Drive.

Blackburn Avenue. At the southeast corner of the intersection of Blackburn Avenue and Claremont Drive, to direct traffic proceeding northerly on Blackburn Avenue to come to a full stop before proceeding across or into Claremont Drive.

Blanchard Street. At the northeast and southwest corners of the intersection of Blanchard Street and Webster Street, to direct traffic proceeding easterly or westerly on Blanchard Street to come to a full stop before proceeding across or into Webster Street.

Blanchard Street. At the northeast corner of the intersection of Blanchard Street and Dunham Road, to direct vehicular traffic proceeding westerly on Blanchard Street to come to a full stop before proceeding across or into Dunham Road.

Blodgett Avenue. At the southeast corner of the intersection of Blodgett Avenue and 59th Street, to direct vehicular traffic proceeding northerly on Blodgett Avenue to come to a full stop before proceeding across or into 59th Street.

Blodgett Avenue. At the southeast corner of the intersection of Blodgett Avenue and Maple Avenue, to direct vehicular traffic proceeding northerly on Blodgett Avenue to come to a full stop before proceeding across or into Maple Avenue.

Bolson Drive. At the southwest corner of the intersection of Bolson Drive and Dunham Road, to direct vehicular traffic proceeding easterly on Bolson Drive to come to a full stop before proceeding across or into Dunham Road.

Bolson Drive. At the northeast corner of the intersection of Bolson Drive and Woodward Avenue, to direct vehicular traffic proceeding westerly on Bolson Drive to come to a full stop before proceeding across or into Woodward Avenue.

Brookbank Road. At the southeast and northwest corners of the intersection of Brookbank Road and 59th Street, to direct vehicular traffic proceeding northerly and southerly on Brookbank Road to come to a full stop before proceeding across or into 59th Street.

Brookbank Road. At the southeast corner of the intersection of Brookbank Road and Gilbert Avenue, to direct vehicular traffic proceeding northerly on Brookbank Road to come to a full stop before proceeding across or into Gilbert Avenue.

Parking & Traffic

Brookbank Road. At the southeast and northwest corners of the intersection of Brookbank Road and Maple Avenue, to direct vehicular traffic proceeding northerly and southerly on Brookbank Road to come to a full stop before proceeding across or into Maple Avenue.

Brookside Drive. At the southwest corner of the intersection of Brookside Drive and Fairview Avenue, to direct vehicular traffic proceeding easterly on Brookside Drive to come to a full stop before proceeding across or into Fairview Avenue.

Brookside Lane. At the southwest corner of the intersection of Brookside Lane and Saratoga Avenue, to direct vehicular traffic proceeding easterly in Brookside Lane to come to a full stop before proceeding into Saratoga Avenue.

Bryan Place. At the northwest corner and the southeast corner of the intersection of Bryan Place and Franklin Street, to direct vehicular traffic proceeding northerly and southerly on Bryan Place to come to a full stop before proceeding across or into Franklin Street.

Bryan Place. At the northwest corner of the intersection of Bryan Place and Rogers Street, to direct vehicular traffic proceeding southerly on Bryan Place to come to a full stop before proceeding across or into Rogers Street.

Bryan Street. At the northwest corner of the intersection of Bryan Street and Grant Street, to direct vehicular traffic proceeding southerly on Bryan Street to come to a full stop before proceeding across or into Grant Street.

Buckingham Place. At the southwest corners of the intersection of Buckingham Place and Fairview Avenue, to direct vehicular traffic proceeding easterly on Buckingham Place to come to a full stop before proceeding across or into Fairview Avenue.

Bunning Drive. At the southwest corner of the intersection of Bunning Drive and Fairview Avenue, to direct vehicular traffic proceeding easterly on Bunning Drive to come to a full stop before proceeding across or into Fairview Avenue.

Burlington Avenue. At the northeast corner of the intersection of Burlington Avenue and Maple Avenue, to direct vehicular traffic proceeding westerly on Burlington Avenue to come to a full stop before proceeding across or into Maple Avenue.

Burlington Avenue. At the southwest corner of the intersection of Burlington Avenue and Fairview Avenue, to direct vehicular traffic proceeding easterly on Burlington Avenue to come to a full stop before proceeding across or into Fairview Avenue.

Burlington Avenue. At the northeast and southwest corners of the intersection of Burlington Avenue and Washington Street, to direct vehicular traffic proceeding westerly and easterly on Burlington Avenue to come to a full stop before proceeding across or into Washington Street.

Butterfield Frontage Road. At the southwest corner of the intersection of Butterfield Frontage Road and Downers Drive to direct vehicular traffic proceeding easterly in Butterfield Frontage Road to come to a full stop before proceeding into Downers Drive.

Camden Road. At the intersection of Camden Road and Devereux Road, to direct traffic proceeding northeasterly or southwesterly on Devereux Road or southerly on Camden Road, to come to a full stop before proceeding across or into said intersection.

Carpenter Street. At the northwest and southeast corners of the intersection of Blanchard Street and Carpenter Street, to direct traffic proceeding northerly and southerly in Carpenter Street to come to a full stop before proceeding across or into Blanchard Street.

Carpenter Street. At the southeast and northwest corners of the intersection of Carpenter Street and 59th Street, to direct vehicular traffic proceeding northerly and southerly on Carpenter Street to come to a full stop before proceeding across or into 59th Street.

Carpenter Street. At the southeast corner of the intersection of Carpenter Street and

Parking & Traffic

Gilbert Avenue, to direct vehicular traffic proceeding northerly on Carpenter Street to come to a full stop before proceeding across or into Gilbert Avenue.

Chase Avenue. At the northwest corner of the intersection of Chase Avenue and Curtiss Street, to direct vehicular traffic proceeding southerly on Chase Avenue to come to a full stop before proceeding across or into Curtiss Street.

Chicago Avenue. At the northeast and southwest corners of the intersection of Chicago Avenue and Fairview Avenue, to direct vehicular traffic proceeding westerly and easterly on Chicago Avenue to come to a full stop before proceeding across or into Fairview Avenue.

Chicago Avenue. At the northeast and southwest corners of the intersection of Chicago Avenue and Main Street, to direct vehicular traffic proceeding westerly and easterly on Chicago Avenue to come to a full stop before proceeding across or into Main Street.

Chicago Avenue. At the southwest corner of the intersection of Chicago Avenue and Cumnor Road, to direct traffic proceeding in an easterly direction on Chicago Avenue to come to a full stop before proceeding into or across Cumnor Road.

Chicago Avenue. At the southwest and northeast corner of the intersection of Chicago Avenue and Cumnor Road, to direct traffic proceeding in an easterly and westerly direction on Chicago Avenue to come to a full stop before proceeding into or across Cumnor Road.

Chicago Avenue. At the southwest and northeast corners of the intersection of Chicago Avenue and Roslyn Road, to direct traffic proceeding in an easterly and westerly direction on Chicago Avenue to come to a full stop before proceeding into or across Roslyn Road.

Claremont Drive. At the southwest corner of the intersection of Claremont Drive and Fairview Avenue, to direct vehicular traffic proceeding easterly on Claremont Drive to come to a full stop before proceeding across or into Fairview Avenue.

Concord Drive. At the southwest corner of the intersection of Concord Drive and Dunham Road, to direct vehicular traffic proceeding easterly on Concord Drive to come to a full stop before proceeding across or into Dunham Road.

Concord Drive. At the northeast corner of the intersection of Concord Drive and Woodward Avenue, to direct vehicular traffic proceeding westerly on Concord Drive to come to a full stop before proceeding across or into Woodward Avenue.

Coralberry Lane. At the southwest corner of the intersection of Coralberry Lane and Venard Road, to direct vehicular traffic proceeding easterly in Coralberry Lane to come to a full stop before proceeding into Venard Road.

Cornell Avenue. At the northwest corner of the intersection of Cornell Avenue and Warren Avenue, to direct vehicular traffic proceeding southerly on Cornell Avenue to come to a full stop before proceeding across or into Warren Avenue.

Cornell Avenue. At the northwest and southeast corners of the intersection of Cornell Avenue and Prairie Avenue, to direct vehicular traffic proceeding southerly and northerly on Cornell Avenue to come to a full stop before proceeding across or into Prairie Avenue.

Cross Street. At the northwest and southeast corners of the intersection of Cross Street and Haddow Street, to direct traffic proceeding northerly or southerly on Cross Street to come to a full stop before proceeding across or into Haddow Street.

Cumnor Road. At the northwest corner of the intersection of Cumnor Road and Burlington Avenue, to direct traffic proceeding southerly on Cumnor Road to come to a full stop before proceeding into Burlington Avenue.

Curtiss Street. At the northeast corner of the intersection of Curtiss Street and Walnut Avenue, to direct vehicular traffic proceeding westerly on Curtiss Street to come to a full stop before proceeding across or into Walnut Avenue.

Curtiss Street. At the southwest corner of the intersection of Curtiss Street and Cornell

Parking & Traffic

Avenue, to direct traffic proceeding easterly on Curtiss Street to come to a full stop before proceeding into Cornell Avenue.

Curtiss Street. At the northeast corner of the intersection of Curtiss Street and Carpenter Street, to direct vehicular traffic proceeding westerly on Curtiss Street to come to a full stop before proceeding across or into Carpenter Street.

Curtiss Street. At the southwest and northwest corners of the intersection of Curtiss Street and Forest Avenue, to direct vehicular traffic proceeding easterly and westerly on Curtiss Street to come to a full stop before proceeding across or into Forest Avenue.

Curtiss Street. At the southwest corner of the intersection of Curtiss Street and Mochel Drive, to direct vehicular traffic proceeding easterly on Curtiss Street to come to a full stop before proceeding across Mochel Drive.

Davis Street. At the southwest corner of the intersection of Davis Street and Fairview Avenue, to direct vehicular traffic proceeding easterly on Davis Street to come to a full stop before proceeding across or into Fairview Avenue.

Davis Street. At the northeast and southwest corners of the intersection of Davis Street and Douglas Road, to direct vehicular traffic proceeding easterly and westerly on Davis Street to come to a full stop before proceeding across or into Douglas Road.

Dearborn Parkway. At the northwest corner of the intersection of Dearborn Parkway and 59th Street, to direct vehicular traffic proceeding southerly on Dearborn Parkway to come to a full stop before proceeding across or into 59th Street.

Downers Drive. At the southeast corner of the intersection of Downers Drive and Brook Drive, to direct vehicular traffic proceeding northerly on Downers Drive to come to a full stop before proceeding across or into Brook Drive.

Downers Drive. At the northwest corner of the intersection of Downers Drive and Chicago Avenue, to Direct vehicular traffic proceeding southerly on Downers Drive to come to a full stop before proceeding across or into Chicago Avenue.

Douglas Road. At the northwest and southeast corners of the intersection of Wilson Street and Douglas Road, to direct vehicular traffic proceeding southerly and northerly on Douglas Road to come to a full stop before proceeding across or into Wilson Street.

Douglas Road. At the northwest and southeast corners of the intersection of Douglas Road and Chicago Avenue, to direct vehicular traffic proceeding southerly and northerly on Douglas Road to come to a full stop before proceeding across or into Chicago Avenue.

Douglas Road. At the northwest and southeast corners of the intersection of Douglas Road and Grant Street, to direct vehicular traffic proceeding southerly and northerly on Douglas Road to come to a full stop before proceeding across or into Grant Street.

Douglas Road. At the northwest corner of the intersection of Douglas Road and Rogers Street, to direct vehicular traffic proceeding southerly on Douglas Road to come to a full stop before proceeding across or into Rogers Street.

Downers Drive. At the southeast and northwest corners of the intersection of Downers Drive and Frontage Road, to direct vehicular traffic proceeding northerly and southerly on Downers Drive to come to a full stop before proceeding across or into Frontage Road.

Dunham Road. At the intersection of Dunham Road and 59th Street, to direct traffic proceeding northerly or southerly on Dunham Road or westerly on 59th Street to come to a full stop before proceeding across or into said intersection.

Earlston Road. At the southeast corner of the intersection of Earlston Road and 39th Street, to direct vehicular traffic proceeding northerly on Earlston Road to come to a full stop before proceeding across or into 39th Street.

Eldon Place. At the northwest corner of the intersection of Eldon Place and 59th Street,

Parking & Traffic

to direct vehicular traffic proceeding southerly on Eldon Place to come to a full stop before proceeding across or into 59th Street.

Elm Street. At the southeast corner of the intersection of Elm Street and 39th Street, to direct vehicular traffic proceeding northerly on Elm Street to come to a full stop before proceeding across or into 39th Street.

Elm Street. At the northwest and southeast corners of the intersection of Elm Street and Chicago Avenue, to direct vehicular traffic proceeding southerly and northerly on Elm Street to come to a full stop before proceeding across or into Chicago Avenue.

Elm Street. At the northwest and southeast corners of the intersection of Elm Street and Grant Street, to direct vehicular traffic proceeding southerly and northerly on Elm Street to come to a full stop before proceeding across or into Grant Street.

Elm Street. At the northwest and southeast corners of the intersection of Elm Street and Rogers Street, to direct vehicular traffic proceeding southerly and northerly on Elm Street to come to a full stop before proceeding across or into Rogers Street.

Elmore Avenue. At the southwest corner of the intersection of Elmore Avenue and Lee Avenue, to direct traffic proceeding in an easterly direction on Elmore Avenue to come to a full stop before proceeding across or into Lee Avenue.

Elmwood Avenue. At the southeast corners of the intersection of Elmwood Avenue and Maple Avenue, to direct vehicular traffic proceeding northerly on Elmwood Avenue to come to a full stop before proceeding across or into Maple Avenue.

Elmwood Avenue. At the northwest corner of the intersection of Elmwood Avenue and Randall Street, regulating southbound traffic on Elmwood Avenue.

Fairmount Avenue. At the northwest corner of the intersection of Fairmount Avenue and 72nd Street, to direct vehicular traffic proceeding southerly on Fairmount Avenue to come to a full stop before proceeding across or into 72nd Street.

Fairmount Avenue. At the southeast corner of the intersection of Fairmount Avenue and Maple Avenue, to direct vehicular traffic proceeding northerly on Fairmount Avenue to come to a full stop before proceeding across or into Maple Avenue.

Fairmount Avenue. At the northwest corner of the intersection of Fairmount Avenue and Oxford Street, to direct traffic proceeding southerly in Fairmount Avenue to come to a full stop before proceeding across or into said intersection.

Florence Avenue. At the northwest and southeast corners of the intersection of Florence Avenue and 6th Street to direct vehicular traffic proceeding northerly or southerly on Florence Avenue to come to a full stop before proceeding into 6th Street.

Florence Avenue. At the southeast corner of the intersection of Florence Avenue and Indianapolis Avenue to direct vehicular traffic proceeding northerly on Florence Avenue to come to a full stop before proceeding into Indianapolis Avenue.

Forest Avenue. At the northwest corner of the intersection of Forest Avenue and Curtiss Street, to direct traffic proceeding southerly on Forest Avenue to come to a full stop before proceeding into Curtiss Street.

Forest Avenue. At the northwest corner of the intersection of Forest Avenue and Sherman Street, to direct traffic proceeding southerly on Forest Avenue to come to a full stop before proceeding into Sherman Street.

Forest Avenue. At the northwest corner of Forest Avenue and Warren Avenue, to direct traffic proceeding southerly on Forest Avenue to come to a full stop before proceeding across or into Warren Avenue.

Forest Avenue. At the southeast corner of the intersection of Forest Avenue and Thirty-Ninth Street to direct traffic proceeding northerly on Forest Avenue to come to a full stop

Parking & Traffic

before proceeding into Thirty-Ninth Street.

Forest Avenue. At the southeast corner of the intersection of Forest Avenue and 41st Street to direct vehicular traffic proceeding northerly on Forest Avenue to come to a full stop before proceeding into 41st Street.

Forest Avenue. At the intersection of Forest Avenue and Franklin Street, to direct traffic proceeding northerly or southerly on Forest Avenue or easterly on Franklin Street, to come to a full stop before proceeding across or into said intersection.

Forest Avenue. At the northwest and southeast corners of the intersection of Forest Avenue and Chicago Avenue, to direct vehicular traffic proceeding southerly and northerly on Forest Avenue to come to a full stop before proceeding across or into Chicago Avenue.

Forest Avenue. At the northwest corner of the intersection of Forest Avenue and Warren Avenue, to direct vehicular traffic proceeding southerly on Forest Avenue to come to a full stop before proceeding across or into Warren Avenue.

Franklin Street. At the northeast and southwest corners of the intersection of Franklin Street and Elm Street, to direct traffic proceeding easterly or westerly on Franklin Street to come to a full stop before proceeding across or into Elm Street.

Franklin Street. At the northeast and southwest corners of the intersection of Franklin Street and Highland Avenue, to direct traffic proceeding easterly or westerly on Franklin Street to come to a full stop before proceeding across or into Highland Avenue.

Gierz Street. At the southwest and northeast corners of the intersection of Gierz Street and Douglas Road, to direct vehicular traffic proceeding easterly and westerly on Gierz Street to come to a full stop before proceeding into Douglas Road.

Gierz Street. At the northeast and southwest corners of the intersection of Gierz Avenue and Fairview Avenue, to direct vehicular traffic proceeding westerly and easterly on Gierz Avenue to come to a full stop before proceeding across or into Fairview Avenue.

Glendenning Street. At the southeast and northwest corner of the intersection of Glendenning Street and 39th Street, to direct vehicular traffic proceeding northerly and southerly on Glendenning Street to come to a full stop before proceeding across or into 39th Street.

Grand Avenue. At the southeast corner of the intersection of Grand Avenue and 59th Street, to direct vehicular traffic proceeding northerly on Grand Avenue to come to a full stop before proceeding across or into 59th Street.

Grand Avenue. At the intersection of Grand Avenue and 74th Street, to direct traffic proceeding northerly or southerly on Grand Avenue or westerly on 74th Street, to come to a full stop before proceeding across or into said intersection.

Grand Avenue. At the southeast corner of the intersection of Grand Avenue and Burlington Avenue, regulating northbound traffic on Grand Avenue.

Grant Street. At the northeast corner and the southwest corner of the intersection of Grant Street and Cumnor Road, to direct vehicular traffic proceeding easterly or westerly on Grant Street to come to a full stop before proceeding across or into Cumnor Road.

Grant Street. At the southwest and northeast corners of the intersection of Grant Street and Fairview Avenue, to direct vehicular traffic proceeding easterly and westerly on Grant Street to come to a full stop before proceeding across or into Fairview Avenue.

Grove Street. At the northeast corner of the intersection of Grove Street and Carpenter Street, to direct vehicular traffic proceeding westerly on Grove Street to come to a full stop before proceeding across or into Carpenter Street.

Grove Street. At the southwest corner of the intersection of Grove Street and Main Street, to direct vehicular traffic proceeding easterly on Grove Street to come to a full stop before proceeding across or into Main Street.

Parking & Traffic

Haddow Street. At the northeast corner of the intersection of Haddow Street and Cross Street to direct traffic proceeding westerly on Haddow Street to come to a full stop before proceeding into Cross Street.

Hastings Avenue. At the northeast corner of the intersection of Hastings Avenue and Woodward Avenue, to direct vehicular traffic proceeding westerly on Hastings Avenue to come to a full stop before proceeding across or into Woodward Avenue.

Highland Avenue. At the northwest and southeast corners of the intersection of Highland Avenue and 41st Street, to direct vehicular traffic proceeding southerly and northerly on Highland Avenue to come to a full stop before proceeding across or into 41st Street.

Highland Avenue. At the northwest and southeast corners of the intersection of Highland Avenue and Rogers Street, to direct vehicular traffic proceeding southerly and northerly on Highland Avenue to come to a full stop before proceeding across or into Rogers Street.

Hillcrest Road. At the northwest corner of the intersection of Hillcrest Road and Jefferson Avenue, regulating southbound traffic on Hillcrest Road.

Hitchcock Avenue. At the southwest corner of the intersection of Hitchcock Avenue and Cornell Avenue, to direct traffic proceeding easterly on Hitchcock Avenue to come to a full stop before proceeding into Cornell Avenue.

Hitchcock Avenue. At the southwest corner of the intersection of Hitchcock Avenue and Walnut Avenue, to direct vehicular traffic proceeding easterly on Hitchcock Avenue to come to a full stop before proceeding across or into Walnut Avenue.

Indianapolis Avenue. At the southwest and northeast corners of the intersection of Indianapolis Avenue and Fairview Avenue, to direct vehicular traffic proceeding easterly and westerly on Indianapolis Avenue to come to a full stop before proceeding across or into Fairview Avenue.

Indianapolis Avenue. At the northeast and southwest corners of the intersection of Indianapolis Avenue and Florence Avenue, to direct vehicular traffic proceeding easterly and westerly on Indianapolis Avenue to come to a full stop before proceeding across or into Florence Avenue.

Jacqueline Drive. At the southeast corner of the intersection of Jacqueline Drive and Gilbert Avenue, to direct vehicular traffic proceeding northerly on Jacqueline Drive to come to a full stop before proceeding across or into Gilbert Avenue.

Janet Street. At the northeast and southwest corners of the intersection of Janet Street and Downers Drive to direct traffic proceeding easterly or westerly on Janet Street to come to a full stop before proceeding into or across Downers Drive.

Jefferson Avenue. At the northeast corner of the intersection of Jefferson Avenue and Springside Avenue, to direct vehicular traffic proceeding westerly on Jefferson Avenue to come to a full stop before proceeding into Springside Avenue.

Jefferson Avenue. At the northeast and southwest corners of the intersection of Jefferson Avenue and Hillcrest Road, regulating westbound and eastbound traffic on Jefferson Avenue.

Jefferson Avenue. At the southwest and northeast corners of the intersection of Jefferson Avenue and Dunham Road, to direct vehicular traffic proceeding easterly and westerly on Jefferson Avenue to come to a full stop before proceeding across or into Dunham Road.

Katrine Avenue. At the southeast corner of the intersection of Katrine Avenue and Curtiss Street, to direct vehicular traffic proceeding northerly on Katrine Avenue to come to a full stop before proceeding across or into Curtiss Street.

Lake Avenue. At the southwest corner of the intersection of Lake Avenue and Fairview Avenue, to direct vehicular traffic proceeding easterly on Lake Avenue to come to a full stop before proceeding across or into Fairview Avenue.

Parking & Traffic

Lane Place. At the southeast corner of the intersection of Lane Place and Maple Avenue, to direct vehicular traffic proceeding northerly on Lane Place to come to a full stop before proceeding across or into Maple Avenue.

Lee Avenue. At the southeast corner of the intersection of Lee Avenue and Gilbert Avenue, to direct vehicular traffic proceeding northerly on Lee Avenue to come to a full stop before proceeding across or into Gilbert Avenue.

Lee Avenue. At the southeast and northwest corners of the intersection of Lee Avenue and Prairie Avenue, to direct vehicular traffic proceeding northerly and southerly on Lee Avenue to come to a full stop before proceeding across or into Prairie Avenue.

Lincoln Street. At the northeast and southwest corners of the intersection of Lincoln Avenue and Main Street, to direct vehicular traffic proceeding westerly and easterly traffic on Lincoln Avenue to come to a full stop before proceeding across or into Main Street.

Lincoln Street. At the northeast and southwest corners of the intersection of Lincoln Street and Linscott Avenue, to direct vehicular traffic proceeding easterly and westerly on Lincoln Street to come to a full stop before proceeding into or across Linscott Avenue.

Lincoln Street. At the northeast and southwest corners of the intersection of Lincoln Street and Saratoga Avenue, to direct traffic proceeding easterly or westerly on Lincoln Street to come to a full stop before proceeding into or across Saratoga Avenue.

Lincoln Street. At the northeast and southwest corners of the intersection of Lincoln Street and Forest Avenue, to direct traffic proceeding easterly or westerly on Lincoln Street to come to a full stop before proceeding into or across Forest Avenue.

Lincoln Street. At the northeast and southwest corners of the intersection of Lincoln Street and Highland Avenue, to direct traffic proceeding easterly or westerly on Lincoln Street to come to a full stop before proceeding into or across Highland Avenue.

Lincoln Street. At the northeast corner of the intersection of Lincoln Street and Middaugh Avenue, to direct traffic proceeding westerly on Lincoln Street to come to a full stop before proceeding into or across Middaugh Avenue.

Lincoln Street. At the northeast and southwest corners of the intersection of Lincoln Street and Elm Street to direct vehicular traffic proceeding easterly or westerly on Lincoln Street to come to a full stop before proceeding across or into Elm Street.

Linden Place. At the southeast corner of the intersection of Linden Place and Chicago Avenue, to direct vehicular traffic proceeding northerly on Linden Place to come to a full stop before proceeding across or into Chicago Avenue.

Linden Place. At the northwest corner of the intersection of Linden Place and Rogers Street, to direct vehicular traffic proceeding southerly on Linden Place to come to a full stop before proceeding across or into Rogers Street.

Lindley Street. At the intersection of Lindley Street and 41st Street, to direct traffic proceeding northerly or southerly on Lindley Street to come to a full stop before proceeding across or into 41st Street.

Linscott Avenue. At the southeast and northwest corners of the intersection of Linscott Avenue and Chicago Avenue, to direct vehicular traffic proceeding northerly and southerly on Linscott Avenue to come to a full stop before proceeding across or into Chicago Avenue.

Loomes Avenue. At the northeast corner of the intersection of Loomes Avenue and Woodward Avenue, to direct traffic proceeding westerly on Loomes Avenue to come to a full stop before proceeding across or into Woodward Avenue.

Lyman Avenue. At the southeast and northwest corners of the intersection of Lyman Avenue and 59th Street, to direct vehicular traffic proceeding northerly and southerly on Lyman Avenue to come to a full stop before proceeding across or into 59th Street.

Parking & Traffic

Mackie Place. At the northwest corner of the intersection of Mackie Place and Maple Avenue, to direct vehicular traffic proceeding southerly on Mackie Place to come to a full stop before proceeding across or into Maple Avenue.

Maplewood Place. At the southeast corner of the intersection of Maplewood Place and Maple Avenue, to direct vehicular traffic proceeding northerly on Maplewood Place to come to a full stop before proceeding across or into Maple Avenue.

Middaugh Avenue. At the northwest and southeast corners of the intersection of Middaugh Avenue and Chicago Avenue, to direct vehicular traffic proceeding southerly and northerly on Middaugh Avenue to come to a full stop before proceeding across or into Chicago Avenue.

Middaugh Avenue. At the northwest corner of the intersection of Middaugh Avenue and 59th Street, to direct vehicular traffic proceeding southerly on Middaugh Avenue to come to a full stop before proceeding across or into 59th Street.

Mochel Drive. At the southeast and southwest corners of the intersection of Mochel Drive and Burlington Avenue, to direct vehicular traffic proceeding northerly on Mochel Drive to come to a full stop before proceeding across or into Burlington Avenue.

Montgomery Avenue. At the southeast and northwest corners of the intersection of Montgomery Avenue and Prairie Avenue, to direct vehicular traffic proceeding northerly and southerly on Montgomery Avenue to come to a full stop before proceeding across or into Prairie Avenue.

Northcott Avenue. At the southeast and northwest corners of the intersection of Northcott Avenue and Prairie Avenue, to direct vehicular traffic proceeding northerly and southerly on Northcott Avenue to come to a full stop before proceeding across or into Prairie Avenue.

Oxnard Drive. At the northeast and southwest corners of the intersection of Oxnard Drive and Woodward Avenue, to direct vehicular traffic proceeding westerly and easterly on Oxnard Drive to come to a full stop before proceeding across or into Woodward Avenue.

Pershing Avenue. At the southeast and northwest corners of the intersection of Pershing Avenue and Prairie Avenue, to direct vehicular traffic proceeding northerly and southerly on Pershing Avenue to come to a full stop before proceeding across or into Prairie Avenue.

Powell Street. At the southeast and northwest corners of the intersection of Powell Street and Norfolk Street to direct traffic proceeding northerly and southerly on Powell Street to come to a full stop before proceeding into or across Norfolk Street.

Powell Street. At the northwest and southeast corners of the intersection of Powell Street and 68th Street to direct vehicular traffic proceeding northerly or southerly on Powell Street to come to a full stop before proceeding into 68th Street.

Prince Street. At the northwest and southeast corners of the intersection of Prince and Lincoln Streets, to direct traffic proceeding northerly or southerly on Prince Street to come to a full stop before proceeding into or across Lincoln Street.

Prince Street. At the southeast and northwest corners of the intersection of Prince Street and Chicago Avenue, to direct vehicular traffic proceeding northerly and southerly on Prince Street to come to a full stop before proceeding across or into Chicago Avenue.

Prospect Avenue. At the northwest corner of the intersection of Prospect Avenue and Chicago Avenue, to direct vehicular traffic proceeding southerly on Prospect Avenue to come to a full stop before proceeding across or into Chicago Avenue.

Prospect Avenue. At the northwest and southeast corners of the intersection of Prospect Avenue and Rogers Street, to direct vehicular traffic proceeding southerly and northerly on Prospect Avenue to come to a full stop before proceeding across or into Rogers Street.

Prospect Avenue. At the northwest and southeast corners of the intersection of Franklin

Parking & Traffic

Street and Prospect Avenue, to direct traffic proceeding northerly or southerly on Prospect Avenue to come to a full stop before proceeding across or into Franklin Street.

Puffer Road. At the southeast corner of the intersection of Puffer Road and Haddow Avenue to direct traffic proceeding northerly on Puffer Road to come to a full stop before proceeding into or across Haddow Avenue.

Randall Street. At the intersection of Randall Street and Lyman Avenue, to direct traffic proceeding easterly or westerly on Randall Street to come to a full stop before proceeding across or into Lyman Avenue.

Randall Street. At the northwest and southeast corners of the intersection of Randall Street and Benton Avenue, to direct vehicular traffic proceeding northerly and southerly on Benton Avenue to come to a full stop before proceeding across or into Randall Street.

Randall Street. At the southwest corner of the intersection of Randall Street and Elmwood Avenue, regulating the eastbound traffic on Randall Street.

Randall Street. At the northwest and southeast corners of the intersection of Randall Street and Fairmount Avenue to direct vehicular traffic proceeding northerly or southerly on Fairmount Avenue to come to a full stop before proceeding into Randall Street.

Randall Street. At the northeast and southwest corners of the intersection of Randall Street and Washington Street, to direct vehicular traffic proceeding easterly and westerly on Randall Street to come to a full stop before proceeding across or into Washington Street.

Ridgewood Circle. At the southwest corner of the intersection of Ridgewood Circle and Dunham Road, to direct vehicular traffic proceeding easterly on Ridgewood Circle to come to a full stop before proceeding across or into Dunham Road.

Rogers Street. At the northeast corner of the intersection of Rogers Street and Main Street, to direct vehicular traffic proceeding westerly on Rogers Street to come to a full stop before proceeding across or into Main Street.

Rogers Street. At the southwest corner of the intersection of Rogers Street and Maple Avenue, to direct vehicular traffic proceeding easterly on Rogers Street to come to a full stop before proceeding across or into Maple Avenue.

Ross Court. At the southwest corner of the intersection of Ross Court and Carpenter Street, to direct vehicular traffic proceeding easterly on Ross Court to come to a full stop before proceeding across or into Carpenter Street.

Saratoga Avenue. At the intersection of Saratoga Avenue and Black Oak Drive, to direct traffic proceeding northerly or southerly on Saratoga Avenue or westerly on Black Oak Drive to come to a full stop before proceeding across or into said intersection.

Saratoga Avenue. At the southeast corner and the northwest corner of the intersection of Saratoga Avenue and 35th Street, to direct traffic proceeding northerly or southerly on Saratoga Avenue to come to a full stop before proceeding across or into 35th Street.

Saratoga Avenue. At the southeast corner of the intersection of Saratoga Avenue and 41st Street, to direct vehicular traffic proceeding northerly on Saratoga Avenue to come to a full stop before proceeding across or into 41st Street.

Saratoga Avenue. At the northwest corner of the intersection of Saratoga Avenue and Norfolk Street to direct traffic proceeding southerly on Saratoga Avenue to come to a full stop before proceeding across or into Norfolk Street.

Saylor Street. At the northeast corner of the intersection of Saylor Street and Dunham Road, to direct vehicular traffic proceeding westerly on Saylor Street to come to a full stop before proceeding across or into Dunham Road.

Seeley Avenue. At the southeast and northwest corners of the intersection of Seeley Avenue and Prairie Avenue, to direct vehicular traffic proceeding northerly and southerly on

Parking & Traffic

Seeley Avenue to come to a full stop before proceeding across or into Prairie Avenue.

Sheridan Place. At the northeast corner of the intersection of Sheridan Place and Washington Street, to direct vehicular traffic proceeding westerly on Sheridan Place to come to a full stop before proceeding across or into Washington Street.

Sherman Street. At the southwest corner of the intersection of Sherman Street and Fairview Avenue, to direct vehicular traffic proceeding easterly on Sherman Street to come to a full stop before proceeding across or into Fairview Avenue.

Sherman Street. At the northeast corner and the southwest corner of the intersection of Sherman Street and Stanley Avenue, to direct vehicular traffic proceeding easterly or westerly on Sherman Street to come to a full stop before proceeding across or into Stanley Avenue.

Sherwood Avenue. At the northwest corner of the intersection of Sherwood Avenue and Chicago Avenue, to direct vehicular traffic proceeding southerly on Sherwood Avenue to come to a full stop before proceeding across or into Chicago Avenue.

Sherwood Avenue. At the southeast corner of the intersection of Sherwood Avenue and Grant Street, to direct vehicular traffic proceeding northerly on Sherwood Avenue to come to a full stop before proceeding across or into Grant Street.

Stanford Avenue. At the northeast corner of the intersection of Stanford Avenue and Dunham Road, to direct vehicular traffic proceeding westerly on Stanford Avenue to come to a full stop before proceeding across or into Dunham Road.

Stanley Avenue. At the northwest corner of the intersection of Stanley Avenue and Chicago Avenue, to direct vehicular traffic proceeding southerly on Stanley Avenue to come to a full stop before proceeding across or into Chicago Avenue.

Stanley Avenue. At the northwest and southeast corners of the intersection of Stanley Avenue and Grant Street, to direct vehicular traffic proceeding southerly and northerly on Stanley Avenue to come to a full stop before proceeding across or into Grant Street.

Stanley Avenue. At the northwest corner of the intersection of Stanley Avenue and Rogers Street, to direct vehicular traffic proceeding southerly on Stanley Avenue to come to a full stop before proceeding across or into Rogers Street.

Stanley Avenue. At the northwest and southeast corners of the intersection of Franklin Street and Stanley Avenue, to direct traffic proceeding northerly or southerly on Stanley Avenue to come to a full stop before proceeding across or into Franklin Street.

Station Street. At the southeast corner of the intersection of Station Street and Grant Street, to direct vehicular traffic proceeding northerly on Station Street to come to a full stop before proceeding across or into Grant Street.

Sterling Road. At the northwest and southeast corners of the intersection of Sterling Road and 41st Street, to direct vehicular traffic proceeding northerly and southerly on Sterling Road to come to a full stop before proceeding across or into 41st Street.

Sterling Road. At the southeast and northwest corners of the intersection of Sterling Road and 39th Street, to direct vehicular traffic proceeding northerly and southerly on Sterling Road to come to a full stop before proceeding across or into 39th Street.

Sterling Road. At the northwest corner of the intersection of Sterling Road and Chicago Avenue, to direct vehicular traffic proceeding southerly on Sterling Road to come to a full stop before proceeding across or into Chicago Avenue.

Stonewall Avenue. At the northwest and southeast corners of the intersection of Stonewall Avenue and Prairie Avenue, to direct vehicular traffic proceeding southerly and northerly on Stonewall Avenue to come to a full stop before proceeding across or into Prairie Avenue.

Parking & Traffic

Stonewall Avenue. At the northwest and southeast corners of the intersection of Stonewall Avenue and Grant Street, to direct traffic proceeding northerly or southerly on Stonewall Avenue to come to a full stop before proceeding into or across Grant Street.

Summit Street. At the southwest corner of the intersection of Summit Street and Washington Street, to direct vehicular traffic proceeding easterly on Summit Street to come to a full stop before proceeding into Washington Street.

Summit Street. At the northeast and southwest corners of the intersection of Summit Street and Main Street, to direct vehicular traffic proceeding westerly and easterly on Summit Street to come to a full stop before proceeding across or into Main Street.

Thatcher Road. At the southwest corner of Thatcher Road and Walnut Avenue, to direct vehicular traffic proceeding easterly on Thatcher Road to come to a full stop before proceeding into or across Walnut Avenue.

Thornwood Drive. At the southwest corner of the intersection of Thornwood Drive and Dunham Road, to direct vehicular traffic proceeding easterly on Thornwood Drive to come to a full stop before proceeding across or into Dunham Road.

Traube Avenue. At the southwest and northeast corners of the intersection of Traube Avenue and Roslyn Road, to direct traffic proceeding in an easterly and westerly direction on Traube Avenue to come to a full stop before proceeding into or across Roslyn Road.

Wall Place. At the northwest corner of the intersection of Wall Place and 59th Street, to direct vehicular traffic proceeding southerly on Wall Place to come to a full stop before proceeding across or into 59th Street.

Wallbank Avenue. At the northwest and southeast corners of the intersection of Wallbank Avenue and Prairie Avenue, to direct vehicular traffic proceeding southerly and northerly on Wallbank Avenue to come to a full stop before proceeding across or into Prairie Avenue.

Warren Avenue. At the southeast corner of the intersection of Warren Avenue and Forest Avenue, to direct vehicular traffic proceeding easterly on Warren Avenue to come to a full stop before proceeding across or into Forest Avenue.

Warren Avenue. At the northeast and southwest corners of the intersection of Highland Avenue and Warren Avenue, which signs shall be so located as to direct vehicular traffic proceeding easterly and westerly on Warren Avenue, to come to a full stop before proceeding into Highland Avenue.

Warren Avenue. At the southwest corner of Warren Avenue and Forest Avenue, to direct traffic proceeding easterly on Warren Avenue to come to a full stop before proceeding across or into Forest Avenue.

Warren Avenue. At the northeast corner of Warren Avenue at the East Loop ramp.

Washington Street. At the northwest and southeast corners of the intersection of Washington Street and Blanchard Street, to direct traffic proceeding northerly or southerly on Washington Street to come to a full stop before proceeding across or into Blanchard Street.

Washington Street. At the northwest corner of the intersection of Washington Street and Warren Avenue, to direct traffic proceeding southerly on Washington Street to come to a full stop before proceeding across or into Warren Avenue.

Washington Street. At the northwest and southeast corners of the intersection of Washington Street and 59th Street, to direct vehicular traffic proceeding southerly and northerly on Washington Street to come to a full stop before proceeding across or into 59th Street.

Washington Street. At the northeast and southwest corners of the intersection of Washington Street and Lincoln Avenue, to direct vehicular traffic proceeding westerly and easterly on Washington Street to come to a full stop before proceeding across or into Lincoln Avenue.

Webster Place. At the southeast corner of the intersection of Webster Street and 59th Street, to direct vehicular traffic proceeding northerly on Webster Street to come to a full stop before proceeding across or into 59th Street.

Webster Street. At the northwest corner of the intersection of Webster Street and 59th Street, to

Parking & Traffic

direct vehicular traffic proceeding southerly on Webster Street to come to a full stop before proceeding across or into 59th Street.

Webster Street. At the northwest and southeast corners of the intersection of Webster Street and Kenyon Street, to direct traffic proceeding northerly or southerly on Webster Street to come to a full stop before proceeding across or into Kenyon Street.

Webster Street. At the southeast corner of the intersection of Webster Street and Randall Street, regulating northbound traffic on Webster Street.

Wells Street. At the southwest corner of the intersection of Wells Street and Springside Avenue to direct traffic proceeding easterly on Wells Street to come to a full stop before proceeding across or into Springside Avenue.

Whiffin Place. At the northwest corner of the intersection of Whiffin Place and Rogers Street, to direct vehicular traffic proceeding southerly on Whiffin Place to come to a full stop before proceeding across or into Rogers Street.

Wilson Avenue. At the northwest and southeast corners of the intersection of Wilson Avenue and Grant Street, to direct vehicular traffic proceeding northerly and southerly on Wilson Avenue to come to a full stop before proceeding into Grant Street.

Wilson Avenue. At the northwest corner of the intersection of Wilson Avenue and Chicago Avenue, to direct vehicular traffic proceeding southerly on Wilson Avenue to come to a full stop before proceeding across or into Chicago Avenue.

Wisconsin Avenue. At the northeast corner of Wisconsin Avenue and Walnut Avenue, to direct vehicular traffic proceeding westerly on Wisconsin Avenue to come to a full stop before proceeding across or into Walnut Avenue.

Woodward Avenue. At the northwest and southeast corners of the intersection of Grant Street and Woodward Avenue, to direct traffic proceeding northerly or southerly on Woodward Avenue to come to a full stop before proceeding across or into Grant Street.

Woodward Avenue. At the northwest and southeast corners of the intersection of Woodward Avenue and Prairie Avenue, to direct vehicular traffic proceeding southerly and northerly on Washington Street to come to a full stop before proceeding across or into Prairie Avenue.

2nd Street. At the southwest corner of the intersection of 2nd Street and Williams Street to direct traffic proceeding easterly on 2nd Street to come to a full stop before proceeding into Williams Street.

3rd Street. At the northeast and southwest corners of the intersection of 3rd Street and Florence Avenue, to direct vehicular traffic proceeding easterly and westerly on 3rd Street to come to a full stop before proceeding across or into Florence Avenue.

3rd Street. At the northeast corner of the intersection of 3rd Street and Fairview Avenue, to direct vehicular traffic proceeding westerly on 3rd Street to come to a full stop before proceeding across or into Fairview Avenue.

4th Street. At the northeast corner of the intersection of 4th Street and Fairview Avenue, to direct vehicular traffic proceeding westerly on 4th Street to come to a full stop before proceeding across or into Fairview Avenue.

5th Street. At the northeast and southwest corners of the intersection of 5th Street and Florence Avenue, to direct vehicular traffic proceeding easterly and westerly on 5th Street to come to a full stop before proceeding across or into Florence Avenue.

5th Street. At the northeast corner of the intersection of 5th Street and Fairview Avenue, to direct vehicular traffic proceeding westerly on 5th Street to come to a full stop before proceeding across or into Fairview Avenue.

6th Street. At the northeast corner of the intersection of 6th Street and Fairview Avenue, to direct vehicular traffic proceeding westerly on 6th Street to come to a full stop before proceeding across or into Fairview Avenue.

6th Street. At the southwest and northeast corners of the intersection of 6th Street and Cumnor Road to direct traffic proceeding easterly or westerly on 6th Street to come to a full stop before

Parking & Traffic

proceeding across or into Cumnor Road.

7th Street. At the northeast corner and the southwest corner of the intersection of 7th Street and Cumnor Road, to direct traffic proceeding easterly or westerly on 7th Street to come to a full stop before proceeding across or into Cumnor Road.

7th Street. At the southwest corner of the intersection of 7th and Williams Streets, to direct vehicular traffic proceeding in an easterly direction on 7th Street to come to a full stop before proceeding into or across Williams Street.

7th Street. At the northeast corner of the intersection of 7th Street and Fairview Avenue, to direct vehicular traffic proceeding westerly on 7th Street to come to a full stop before proceeding across or into Fairview Avenue.

40th Place. At the northeast corner of the intersection of 40th Place and Fairview Avenue, to direct vehicular traffic proceeding westerly on 40th Place to come to a full stop before proceeding across or into Fairview Avenue.

40th Street. At the southwest corner of the intersection of 40th Street and Fairview Avenue, to direct vehicular traffic proceeding easterly on 40th Street to come to a full stop before proceeding across or into Fairview Avenue.

41st Street. At the southwest corner of the intersection of 41st Street and Fairview Avenue, to direct vehicular traffic proceeding easterly on 41st Street to come to a full stop before proceeding across or into Fairview Avenue.

41st Street. At the northeast and southwest corners of the intersection of 41st Street and Glendenning Road, to direct vehicular traffic proceeding easterly and westerly on 41st Street to come to a full stop before proceeding across or into Glendenning Road.

41st Street. At the northeast corner of the intersection of 41st Street and Saratoga Avenue, to direct traffic proceeding westerly on 41st Street to come to a full stop before proceeding across or into Saratoga Avenue.

41st Street. At the northeast and southwest corners of the intersection of 41st Street and Washington Street, to direct vehicular traffic proceeding easterly and westerly on 41st Street to come to a full stop before proceeding across or into Washington Street.

41st Street. At the northeast corner and the southwest corner of the intersection of 41st Street and Williams Street, to direct vehicular traffic proceeding easterly or westerly on 41st Street to come to a full stop before proceeding across or into Williams Street.

56th Street. At the northeast corner of the intersection of 56th Street and Fairview Avenue, to direct vehicular traffic proceeding westerly on 56th Street to come to a full stop before proceeding across or into Fairview Avenue.

57th Street. At the southwest corner of the intersection of 57th Street and Fairview Avenue, to direct vehicular traffic proceeding easterly on 57th Street to come to a full stop before proceeding across or into Fairview Avenue.

61st Street. At the northeast corner of the intersection of Brookbank Road and 61st Street, to direct vehicular traffic proceeding westerly on 61st Street to come to a complete stop before proceeding southerly into Brookbank Road.

61st Street. At the northeast and southwest corners of the intersection of Chase Avenue and 61st Street, which signs shall be so located as to direct vehicular traffic proceeding easterly and westerly on 61st Street, to come to a full stop before proceeding into Chase Avenue.

61st Street. At the northeast and southwest corners of the intersection of Puffer Road and 61st Street, which signs shall be located as to direct vehicular traffic proceeding easterly and westerly on 61st Street, to come to a full stop before proceeding into Chase Avenue.

61st Street. At the southwest and northeast corners of the intersection of 61st Street and Chase Avenue, to direct vehicular traffic proceeding easterly and westerly on 61st Street to come to a full stop before proceeding across or into Chase Avenue.

62nd Street. At the southwest corner of the intersection of 62nd Street and Dunham Road, to

Parking & Traffic

direct vehicular traffic proceeding easterly on 62nd Street to come to a full stop before proceeding across or into Dunham Road.

64th Street. At the northeast corner of the intersection of 64th Street and Puffer Road, to direct vehicular traffic proceeding westerly on 64th Street to come to a full stop before proceeding across or into Puffer Road.

66th Street. At the southwest corner of the intersection of 66th Street and Fairview Avenue, to direct vehicular traffic proceeding easterly on 66th Street to come to a full stop before proceeding across or into Fairview Avenue.

67th Court. At the southwest corner of the intersection of 67th Court and Fairview Avenue, to direct vehicular traffic proceeding easterly on 67th Court to come to a full stop before proceeding across or into Fairview Avenue.

67th Place. At the northeast corner of the intersection of 67th Place and Dunham Road, to direct vehicular traffic proceeding westerly on 67th Place to come to a full stop before proceeding across or into Dunham Road.

67th Street. At the northeast and southwest corners of the intersection of 67th Street and Dunham Road, to direct vehicular traffic proceeding westerly and easterly on 67th Street to come to a full stop before proceeding across or into Dunham Road.

68th Street. At the northeast corner of the intersection of 68th Street and Dunham Road, to direct vehicular traffic proceeding westerly on 68th Street to come to a full stop before proceeding across or into Dunham Road.

68th Street. At the southwest corner of the intersection of 68th Street and Fairview Avenue, to direct vehicular traffic proceeding easterly on 68th Street to come to a full stop before proceeding across or into Fairview Avenue.

72nd Street. At the southwest corner of the intersection of 72nd Street and Fairmount Avenue, to direct vehicular traffic proceeding easterly on 72nd Street to come to a full stop before proceeding across or into Fairmount Avenue.

72nd Street. At the northwest intersection of 72nd Street and Fairmount Avenue to direct vehicular traffic proceeding southerly on Fairmount Avenue and easterly on 72nd Street to come to a full stop before proceeding into said intersection.

72nd Street. At the southeast intersection of 72nd Street and Fairmount Avenue to direct vehicular traffic proceeding northerly on Fairmount Avenue and westerly on 72nd Street to come to a full stop before proceeding into said intersection.

73rd Street. At the southwest corner of the intersection of 73rd Street and Fairmount Avenue, to direct vehicular traffic proceeding easterly on 73rd Street to come to a full stop before proceeding across or into Fairmount Avenue.

73rd Street. At the northeast corner of the intersection of 73rd Street and Old Main Street, to direct vehicular traffic proceeding westerly on 73rd Street to come to a full stop before proceeding across or into Old Main Street.

74th Street. At the southwest corner of the intersection of 74th Street and Fairview Avenue, to direct vehicular traffic proceeding easterly on 74th Street to come to a full stop before proceeding across or into Fairview Avenue. (Ord. No. 1023, § 1; Ord. No. 1097, § 1; Ord. No. 1135, § 1; Ord. No. 1136, § 1; Ord. No. 1178, § 1; Ord. No. 1245, § 1; Ord. No. 1303, § 1; Ord. No. 1304, § 1; Ord. No. 1332, §§ 1 to 3; Ord. No. 1353, §§ 1, 2; Ord. No. 1363, § 1; Ord. No. 1364, § 1; Ord. No. 1366, § 1; Ord. No. 1367, § 1; Ord. No. 1368, §§ 1, 2; Ord. No. 1374, §§ 1, 2; Ord. No. 1405, § 1; Ord. No. 1413, § 1; Ord. No. 1435, § 1; Ord. No. 1437, §§ 1, 2; Ord. No. 1444, §§ 1 to 5; Ord. No. 1446, §§ 1 to 4; Ord. No. 1451, § 1; Ord. No. 1454, §§ 1, 2; Ord. No. 1460, § 1; Ord. No. 1461, §§ 1, 2; Ord. No. 1482, § 1; Ord. No. 1487, § 1; Ord. No. 1498, § 1; Ord. No. 1517, § 1; Ord. No. 1538, § 1; Ord. No. 1596, § 1; Ord. No. 1606, § 1; Ord. No. 1607, § 1; Ord. No. 1707, § 3; Ord. No. 1717, § 3; Ord. No. 1722, § 3; Ord. No. 1760, § 5; Ord. No. 1781, § 7; Ord. No. 1815, § 3; Ord. No. 1817, § 4; Ord. No. 1837, § 3; Ord. No. 1866, § 3; Ord. No. 1911, § 3; Ord. No. 1933, § 4; Ord. No. 1946, § 3; Ord. No. 2095, § 4; Ord. No. 2104, § 8; Ord. No. 2141, § 2;

Parking & Traffic

Ord. No. 2219, § 2; Ord. No. 2297, § 2; Ord. No. 2303, § 2; Ord. No. 2323, § 2; Ord. No. 2333, § 2; Ord. No. 2348, § 2; Ord. No. 2352, § 2; Ord. No. 2353, § 2; Ord. No. 2360, § 2; Ord. No. 2372, § 2; Ord. No. 2380, § 2; Ord. No. 2391, § 2; Ord. No. 2485, § 1; Ord. No. 2550, § 4; Ord. No. 2560, § 2; Ord. No. 2611, § 2; Ord. No. 2620, § 2; Ord. No. 2624, § 2; Ord. No. 2663, § 5; Ord. No. 2675, § 2; Ord. No. 2682, § 3; Ord. No. 2788, § 2; Ord. No. 2804, § 2; Ord. No. 2829, § 2; Ord. No. 2844, § 2; Ord. No. 2867, § 2; Ord. No. 2879, § 2; Ord. No. 2899, § 2; Ord. No. 2914, § 2; Ord. No. 2995, § 3; Ord. No. 3022, § 2; Ord. No. 3023, § 2; Ord. No. 3035, § 2; Ord. No. 3102, § 6; Ord. No. 3113, § 2; Ord. No. 3117, § 4; Ord. No. 3123 § 2; Ord. No. 3153 § 2; Ord. No. 3192, § 3; Ord. No. 3269, § 2; Ord. No. 3291, § 2.)

Section 9. That Section 14.80.1. is hereby amended to read as follows:

14.80.1. Four-way stop signs.

There shall be erected in conspicuous places at the following intersections signs lettered with the words "4-Way Stop", which signs shall be so located as to direct all traffic to come to a full stop before proceeding into the intersection:

Barneswood Drive and Saratoga Avenue.
Bolson Drive and Springside Avenue.
Chicago Avenue and Oakwood Avenue.
Chicago Avenue and Saratoga Avenue.
Chicago Avenue and Highland Avenue.
Chicago Avenue and Lee Avenue.
Claremont Drive and Fairmount Avenue.
Curtiss Street and Washington Street.
Douglas Road and Franklin Street.
Downers Drive and Herbert Street.
Downers Drive and 40th Street.
Dunham Road, Andrus Avenue and 71st Street.
Florence Avenue and Grant Street.
Grand Avenue and Hill Street.
Grant Street and Highland Avenue.
Grant Street and Middaugh Avenue.
Grant Street and Oakwood Avenue.
Grant Street and Prince Street.
Grant Street and Saratoga Avenue.
Grant Street and Seeley Avenue.
Hill Street and Blodgett Street.
Kenyon Street and Washington Street.
Lee Avenue and Chicago Avenue.
Lyman Avenue and Summit Street.
Maple Avenue and Carpenter Street.
Maple Avenue and Washington Street.
Norfolk Street and Dunham Road.
Palmer Street and Dunham Road.
Park Avenue and Randall Street.
Prairie Avenue and Douglas Avenue.
Saratoga Avenue and Candlewood Drive.
Seeley Avenue and Chicago Avenue.
Springside Avenue and Concord Drive.
Venard Road and Drove Avenue.
Washington Street and Chicago Avenue.

Parking & Traffic

Washington Street and *Grant Street*.
Washington Street and *Rogers Street*.
39th Street and *Cumnor Road*.
39th Street and *Washington Street*.
59th Street and *Fairmount Avenue*.
61st Street and *Lee Avenue*.
61st Street and *Pershing Avenue*.
61st Street and *Sherman Road*.
61st Street and *Woodward Avenue*.

(Ord. No. 1362, § 1; Ord. No. 1365, § 1; Ord. No. 1558, § 1; Ord. No. 1559, § 1; Ord. No. 1589, § 1; Ord. No. 1654, § 3; Ord. No. 1655, § 3; Ord. No. 1781, § 6; Ord. No. 2024, § 4; Ord. No. 2095, §§ 5, 6; Ord. No. 2104, § 10; Ord. No. 2145, § 2; Ord. No. 2220, § 2; Ord. No. 2352, § 4; Ord. No. 2365, § 2; Ord. No. 2408, § 2; Ord. No. 2409, § 2; Ord. No. 3022, § 3; Ord. No. 3117, § 5; Ord. No. 3123, § 3; Ord. No. 3192, § 2; Ord. No. 3333, § 2.)

Section 10. That Section 14.85. is hereby amended to read as follows:

14.85. Definitions.

- (a) *Automated Pay System*. An electronic device located at a public place under the Village's jurisdiction which receives payment for the privilege of temporarily parking in a specified numbered space for the posted time period.
- (b) *Parking lot*. Real property owned or leased by the Village, other than public streets and alleys, which is designated under the provisions of this division for the principal purpose of parking vehicles.
- (c) *Parking meter*. A mechanical device located upon a public street or sidewalk or in a parking lot within an area designated as a parking meter zone, which device shall record a certain number of minutes by the use of a clock mechanism determining the period of time for which a designated parking space may be lawfully used by the person depositing a coin or a cash key in such parking meter.
- (d) *Parking meter zone*. Those areas designated under Section 14-110 in which vehicles may be lawfully parked for the period of time indicated on parking meter in accordance with the provisions of this division.

For all purposes hereof, *Village parking lots* shall be designated as follows:

Chase Avenue Lot shall be the Village parking lot on the street, situated on the east side of Chase Avenue, between Curtiss Street and extending north to the end of the cul-de-sac.

Lot A sometimes referred to as the Warren Lot, shall be the Village parking lot situated in the block bounded by Main Street, Warren Avenue, Forest Avenue and Burlington-Northern Santa Fe Railroad, Inc., tracks.

Lot B shall mean the Village parking lot situated directly east of the Main Street station and bounded on the north by the Burlington-Northern Santa Fe Railroad, Inc., tracks and on the south by Burlington Avenue.

Lot C shall be the Village parking lot situated in the area adjacent to the south side of Warren Avenue, extending from the east line of Highland Avenue to the west line of Washington Street.

Lot D sometimes referred to as the Gilbert Lot, shall be the Village parking lot situated in the block bounded by Gilbert Street, Forest Avenue, Carpenter Street, extended, and the Burlington-Northern Santa Fe Railroad, Inc. tracks.

Lot F shall be the Village parking lot situated in the area adjacent to the south side of Warren Avenue extending from the east line of Washington Street to a point six hundred sixty-five (665) feet east of the east line of Washington Street.

Lot G sometimes referred to as the West Belmont Lot, shall be the Village on-street parking lot ~~situated in the area bounded by Belmont Road, Burlington Avenue, the Burlington Northern Santa Fe~~

Parking & Traffic

~~Railroad, Inc., tracks and Chase Street, extended~~ located along Burlington/Warren Avenue, bounded by the Burlington-Northern Santa Fe Railroad, Inc., tracks, Rose Street on the west and Pershing Street on the east.

Lot H sometimes referred to as the Belmont Lot, shall be the Village parking lot situated on the south side of the Burlington-Northern Santa Fe Railroad, Inc., tracks west of Belmont Road.

Lot I (Main), sometimes referred to as the primary Fairview Lot, shall be the Village parking lot bounded by Second Street, Fairview Avenue, and the Burlington-Northern Santa Fe Railroad, Inc. tracks, sometimes referred to as the Fairview Lot, shall be the Village parking lot bounded by Second Street, Fairview Avenue, and the Burlington-Northern Santa Fe Railroad, Inc. tracks and that parking lot bounded by Maple Avenue, Fairview Avenue, and Burlington Northern Santa Fe Railroad, Inc. tracks.

Lot I (North), shall be the Village on-street parking lot, along both sides of Burlington Avenue, between Florence Avenue and Cumnor Road.

Lot I (West), shall be the Village parking lot, bounded by the Burlington Northern Santa Fe Railroad, Inc. tracks and Fairview Avenue.

Lot J shall be the Village parking lot situated on the west side of Belmont Road, between Burlington Avenue and Hadow Avenue.

Lot K shall be the Village parking lot situated on the east side of Belmont Road, between the Burlington-Northern Santa Fe Railroad tracks and Hitchcock Avenue.

Lot L shall be the Village parking lot situated in the far corner west of the Village Hall bounded by Burlington Avenue on the north and Curtiss Street on the south.

Lot R shall be located in the lower level of the Parking Deck as designated by the Village Manager.

Lot S shall be located on the top level of the Parking Deck.

Lot W shall be the Village parking lot situated on the south side of Sherman Street, between Prince Street and Main Street and assigned to North High School Student parking.

~~Lot Z shall be on the east side of Springside Avenue from a point four hundred thirty six (436) feet south of the south line of 63rd Street to a point one thousand six hundred ninety three (1,693) feet south of the south line of 63rd Street~~ shall be the Village on-street parking lot, located along the east side of Springside Avenue, from south of 63rd Street to south of Brookwood Drive, adjacent to and assigned to South High School student parking.

Municipal complex parking lots shall be the Village parking lots situated on the municipal complex property, said property being located southeast of the intersection of Burlington Avenue and North Washington Street between Burlington Avenue and Curtiss Street and designated as Lots L and V, as posted.

The Forest Lot South shall be the Village parking lot situated in the block bounded by Main Street, Curtiss Street, Forest Avenue and Burlington Avenue.

The Forest Lot North shall be the Village parking lot situated in the block bounded by Main Street, Burlington Avenue, Forest Avenue and the Burlington-Northern Santa Fe Railroad, Inc. tracks.

The Main Street and Maple Avenue Parking Lot shall be the Village parking lot situated at the northeast corner of Main Street and Maple Avenue.

The Parking Deck, Garage, Facility or Structure shall be the Village-owned surface parking area adjacent to as well as the off-street parking area in the multi-level deck, garage, facility or structure bounded by Washington, Curtiss, Main and Maple, commonly known as 945 Curtiss Street and hereinafter referred to as "the Parking Deck".

Warren Avenue Lot shall be the Village parking lot on the street situated on the north side of Warren Avenue, between Saratoga Avenue and Forest Avenue, as posted. (Ord. No. 1436, § 1; Ord. No. 1542, § 5; Ord. No. 1737, § 4; Ord. No. 1820, § 1; Ord. No. 1989, § § 1, 2; Ord. No. 2102, § 1; Ord. No. 2312, § 1; Ord. No. 2375, § 1; Ord. No. 2473, § 1; Ord. No. 2531, § 5; Ord. No. 2745, § 41; Ord. No. 2831, § 1; Ord. No. 3075, § 5; Ord. No. 3098, § 1; Ord. No. 3118, § 13; Ord. No. 3127 § 3; Ord. No. 3224, § 1.)

Section 11. That Section 14.93. is hereby amended to read as follows:

Parking & Traffic

14.93. Diagonal parking areas.

It shall be unlawful for any person at any time to park any motor vehicle or other vehicle or cause any such vehicle to stand in the diagonal parking areas designated in this section unless such vehicle is parked entirely within a single parking location designated for the parking of vehicles.

The following portions of streets are hereby designated as diagonal parking areas:

Burlington Avenue, on the north side, from a point two hundred ninety-three feet east of the east line of Main Street to a point five hundred forty-seven feet east of the east line of Main Street.

Burlington Avenue, on the south side, from a point one hundred forty feet east of Forest Avenue to Washington Street.

Curtiss Street, on the north side from Forest Avenue to a point two hundred feet west of Main Street and from ~~ninety three feet east of Main Street to a point two hundred seventy eight feet east of Main Street~~, and from Main Street to a point three hundred feet east of Main Street, and from Washington Street to a point one hundred twenty five feet west of Washington Street.

Gilbert Avenue, on the north side, from a point two hundred ninety feet west of the west line of Forest Avenue to a point three hundred seventy-six feet west of the west line of Forest Avenue.

Warren Avenue, on the north side, from Highland Avenue to a point one hundred and ~~fifteen~~^{eighty} feet west of Highland Avenue.

(Ord. No. 1238, §§ 1, 3; Ord. No. 1799, § 10; Ord. No. 2028, § 6; Ord. No. 2745, § 2.)

Section 12. That Section 14.99.1. is hereby amended to read as follows:

14.99.1. No Parking--School bus loading zone.

The following locations are designated as "school bus loading zones" and, except for school owned or controlled buses no person shall park or let stand therein any automobile, motor vehicle or other vehicle at any time on school days:

Douglas Road, on the east side, from the north line of Prairie Avenue to a point one hundred forty (140) feet north of the north line of Prairie Avenue.

Highland Avenue, on the west side from the north line of Franklin Street to a point two hundred twenty (220) feet north of said north line of Franklin Street between the hours of 6:00 A.M. to 9:00 A.M. and 1:30 P.M. to 2:30 P.M.

Hill Street, on the north side, from a point one hundred thirty-four (134) feet west of the west line of Grand Avenue to a point one hundred ninety-four (194) feet west of the west line of Grand Avenue.

Prairie Avenue, on the north side, from the east line of Douglas Road to a point six hundred (600) feet east of the east line of Douglas Road between the hours of 7:00 A.M. to 4:00 P.M.

~~*Prince Street*, on the east side, from a point two hundred fifty (250) feet north of the north line of Lincoln Avenue to Sherman Street.~~

59th Street, on the south side, from the east line of Fairmount Avenue to a point ninety (90) feet west of the west line of Dearborn Parkway, extended. (Ord. No. 2605, § 3; Ord. No. 3146 § 9; Ord. No. 3255, § 3; Ord. No. 3367, § 3.)

Section 13. That Section 14.108. is hereby amended to read as follows:

14.108. Parking places reserved for disabled persons.

(a) The following off-street locations shall be designated as parking reserved for disabled persons:

Municipal Lot A, as posted (two stalls).

Municipal Lot B, as posted (nine stalls).

Municipal Lot C, as posted (three stalls).

Municipal Lot D, as posted (four stalls).

Parking & Traffic

Municipal Lot F, as posted (four stalls).
Municipal Lot G, as posted (six stalls).
Municipal Lot H, as posted (eight stalls).
Municipal Lot I (EastMain), as posted (seven stalls).
Municipal Lot I (West), as posted (two stalls).
Municipal Lot J, as posted (five stalls).
Municipal Lot K, as posted (six stalls).
Municipal Lot L, as posted (four stalls).
Municipal Lot V - Police Department, as posted (four stalls).
Municipal Lot V - Fleet, as posted (two stalls).

The Main Street and Maple Avenue Lot, as posted (one stall)

Municipal Lot - Forest Lot (North), as posted (four stalls).
Municipal Lot - Forest Lot (South), as posted (four stalls).

Municipal Lot - Public Works Facility, at 5101 Walnut, as posted (two stalls).

(b) The following on-street locations shall be designated as parking reserved for disabled persons:

On the south side of Burlington Avenue, from a point one hundred seventy (170) feet east of Mochel Drive, to a point one hundred ninety (190) feet east of Mochel Drive (one stall).

On the north side of Curtiss, from a point twenty-four feet east of Main Street, to a point ninety-three feet east of Main Street (two stalls).

On the north side of Curtiss, from a point one hundred ninety-six feet east of Forest Avenue, to a point two hundred thirty-five feet east of Forest Avenue (two stalls).

On the north side of Warren Avenue, from west of Highland Avenue to a point fifty feet west of the west line of Highland Avenue (one stall).

On the west side of Washington Street, from a point thirty feet north of the north line of Curtiss Street, to a point eighty feet north of the north line of Curtiss Street (two stalls).

On the north side of Warren Avenue, east of Forest Avenue (one stall)

On the north side of Rogers Street, east of Main Street (one stall)

On the west side of Forest Avenue, north of Warren Avenue (one stall)

On the west side of Main Street, south of Franklin Street (two stalls)

On the west side of Mochel Drive, from a point fifty (50) feet north of Curtiss Street, to a point seventy (70) feet north of Curtiss Street (one stall)

(c) No person shall park or let stand any automobile, motor vehicle or other vehicle at any time in any designated access aisle adjacent to any parking place specifically reserved for persons with disabilities, designated by the posting of "disabled parking only" signs or in any area striped with pavement markings or otherwise designated for disabled persons accessibility.

(d) No person shall park or let stand any automobile, motor vehicle or other vehicle at any time in any location in which parking places have been reserved for parking by disabled persons by the use of signs or pavement markings, unless such automobile, motor vehicle or other vehicle is used immediately prior to parking or immediately after parking by or for transportation of a disabled person, as evidenced by display on such vehicle of one of the following:

(1) A disabled registration plate or disabled parking placard issued by the State of Illinois pursuant to its authority under Section 5/3-616 of Chapter 625 of the Illinois Compiled Statutes and displayed by hanging on the rearview mirror of the vehicle, or if no rearview mirror is available, by placement on the dashboard or visor.

(2) A disabled parking placard issued by a municipality pursuant to its authority under Section 5/11-1301.2 of Chapter 625 of the Illinois Compiled Statutes and displayed by hanging on the rearview mirror of the vehicle, or if no rearview mirror is available, by placement on the dashboard or visor.

Parking & Traffic

(e) Any person who violates this section shall be fined not less than two hundred fifty dollars (\$250.00) nor more than five hundred dollars (\$500.00).

(f) A Village of Downers Grove disabled parking placard can be obtained upon a showing by adequate documentation that the person for whose benefit the placard is to be issued has a Class 1A or 2A disability under the provisions of Section 4A of the Illinois Identification Card Act. (15 ILCS 335/4A) The cost for obtaining such a placard or a replacement placard shall be as set forth in Administrative Regulation entitled "User-Fee, License and Fine Schedule".

(g) It shall not be a defense to a charge under this section that either the sign posted pursuant to this section or the intended accessible parking place does not comply with the technical requirements of state law 625ILCS 5/11-301 or of this local ordinance if a reasonable person would be made aware by the sign or notice on or near the parking place that the place is reserved for a person with disabilities. (See similar State law at 625ILCS 5/11-1301.3(c)). (Ord. No. 2001, § 1; Ord. No. 2522, § 1; Ord. No. 2745, § 39; Ord. No. 2860, § 2.)

Section 14. That Section 14.108.1. is hereby amended to read as follows:

14.108.1. Motorcycle parking.

There is hereby established, free motorcycle parking zones in the following locations:

~~——— *Forest Avenue*, on the east side, from a point twenty feet south of the south line of Burlington Avenue to a point ninety four feet south of the south line of Burlington Avenue.~~

Parking Deck, within Level 1, along the north and west walls, as posted and striped.

No person shall park or let stand any automobile, motor vehicle or other vehicle, except a motorcycle, at any of the above-mentioned locations. (Ord. No. 2042, § 2; Ord. No. 2745, § 2.)

Section 15. That Section 14.114. is hereby amended to read as follows:

14.114. Citation; final notice; compromise payments; penalties.

(a) Any person charged with a violation of any of the provisions of paragraphs (a), (b) or (f) of Section 14-113 may settle and compromise such charge by paying to the Village, within fourteen days after the time of the police department citation alleging such charge, ~~a sum determined in accordance with the following schedule:~~

<u>Parking</u>	
<u>Meter</u>	
<u>Zone</u>	<u>Fine</u>
12 minute	25.00
24 minute	25.00
2 hour	25.00
4 hour	25.00
9 hour	25.00
12 hour	25.00

(b) If such compromise payment has not been made prior to the expiration of fourteen days from the date of the police department citation alleging such charge, the police department shall cause to be mailed by first class United States mail, addressed to the last known address of the registered owner of the vehicle involved in the offense so charged, a final notice referring to the offense so charged. At any time prior to the expiration of fourteen days from the date of mailing of such final notice, any person charged with a violation of the provisions of paragraphs (a), (b) or (f) of Section 14-113 may settle and compromise such charge by paying to the Village the ~~amount of the fine established in paragraph (a) of this section together with an additional~~ sum of twenty-five dollars (\$25.00) for each offense so charged.

Parking & Traffic

(c) All such compromise payments may be made at the Village police station and receipts shall be issued by the police department for all payments so received; all such payments shall be promptly delivered to the Village collector and credited to the proper account of the Village. In each case in which such compromise payment is made, the police department is authorized to waive further prosecution of such alleged violation.

(d) Any person found guilty of a violation of any provision of this division shall be subject to a fine of not less than twenty-five dollars (\$25.00) and not more than one hundred fifty dollars (\$150.00) for each such violation. (Ord. No. 1436, § 1; Ord. No. 1737, §§ 2, 3; Ord. No. 1931, § 2; Ord. No. 2331, §§ 1, 2; Ord. No. 2745, § 43; Ord. No. 3115, § 2.)

Section 16. That Section 14.116. is hereby amended to read as follows:

14.116. Free overnight parking lots--Designation.

The following portions of village parking lots, as such lots are defined in Section 14-85.9, are hereby designated as free overnight parking lots:

~~_____ (a) The Curtiss parking lot, as posted.~~

~~_____ (c) That part of Lot I, fourteen feet north of the Burlington Northern tracks, from forty eight feet west of the west line of Fairview Avenue to one hundred fifty six feet west of the west line of Fairview Avenue.~~

(d) Lot G: ~~The south twenty feet of the east one hundred eight feet~~ twelve (12) designated spaces as posted.

~~_____ (e) Lot D, as posted.~~ (Ord. No. 2745, § 44; Ord. No. 2845, § 1; Ord. No. 3118, §§ 14, 15; Ord. No. 3254, § 7; Ord. No. 3349, § 1.)

Section 17. That Section 14.117. is hereby amended to read as follows:

14.117. Periods of free parking.

~~_____ Persons may park vehicles in the free overnight parking lots designated in Section 14-116, without payment of a fee, during the following periods: between 6:00 P.M. of any day and 6:00 A.M. on the following day; at any time on Sunday; at any time on legal holidays. Reserved. (Ord. No. 2745, § 44.)~~

Section 18. That Section 14.159. is hereby amended to read as follows:

14.159. Grove Shuttle Parking.

Areas for the exclusive purpose of loading and unloading passengers of the Grove Commuter Shuttle bus system are hereby designated. No person shall park or let stand any automobile, motorcycle, or other vehicle except Village owned or operated buses in the following location(s):

The south side of Warren Avenue, from a point ninety (90) feet east of the east line of Main Street to a point one hundred and eighty (180) feet east of the east line of Main Street.

The north side of Burlington Avenue, from a point one hundred sixty (160) feet east of the east line of Main Street to a point two hundred fifty (250) feet east of the east line of Main Street.

The south side of Burlington Avenue, north of the Burlington-Northern Santa Fe Railroad, Inc. tracks, west of Belmont Road and across from the West Loop ramp/Burlington Avenue intersection, during the PM peak period.

Parking & Traffic

The northeast corner of Lot "H", adjacent to the train station, during the AM peak period.

(Ord. No. 2271, § 1; Ord. No. 2745, § 2.)

Section 19. That all ordinances or parts of ordinances in conflict with the provisions of this ordinance are hereby repealed.

Section 20. That this ordinance shall be in full force and effect from and after its passage and publication in the manner provided by law.

Mayor

Passed:

Published:

Attest: _____
Village Clerk

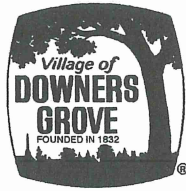

Village of Downers Grove
Public Works
Memo

REVISED

To: David Fieldman, Village Manager
From: Naneil Newlon, Director of Public Works
By: Dorin Fera, PTP, AICP, Transportation Division Manager
Date: July 23, 2012
Subject: **Request For Approval**
Temporary Suspension of Regulations – Burlington Rd at Belmont Road Interchange

In accordance with Chapter 14-4 of the Downers Grove Municipal Code, a request is hereby made for the temporary suspension of regulations associated with the following streets as described below:

- Install All-Way STOP signs at Burlington Road at the New Belmont Road WEST Ramp
- Install STOP control for the New Belmont Road EAST Ramp
- Incorporate the new parking spaces south side of Warren Avenue, between Belmont Road and Pershing Ave, into existing Lot G

With the completion of the Belmont Road improvements, this interchange needs to be upgraded in the Village's ordinance system to be in compliance with the constructed roadways. Staff believes that due to the anticipated volume of both pedestrian and vehicular traffic at this location, it is important to upgrade the WEST Ramp to a full All-way STOP control to provide an enhanced level of safety. With this upgrade and the STOP-control at the EAST Ramp, the traffic and pedestrian conflicts will be greatly reduced.

The new parking spaces on Warren Avenue have never been associated with any Village Lot. Staff believes that with the overall circulation and parking improvements being completed, it makes sense now to officially incorporate this parking area into a Village lot, for operations and enforcement.

This temporary condition will remain in effect for a period of sixty (60) days. Staff will be monitoring the performance at this location during this temporary period, and is scheduling this item for the September 12, 2012 Transportation and Parking Commission meeting.

Director of Public Works Recommendation: Naneil Newlon Date: 7/23/2012
Chief of Police Concurrence: Robert A. Fera Date: 7/24/12
Village Manager Approval: David Fieldman Date: 7/31/12

c: Enza Petrarca, Village Attorney
Tim Sembach, Police Department
Harry Andler, Police Department

PARKING AND OPERATIONAL CHANGES BELMONT ROAD METRA TRAIN STATION TAP COMMISSION FILE #15-12

EXHIBIT 1



r.w.b.
08/29/12

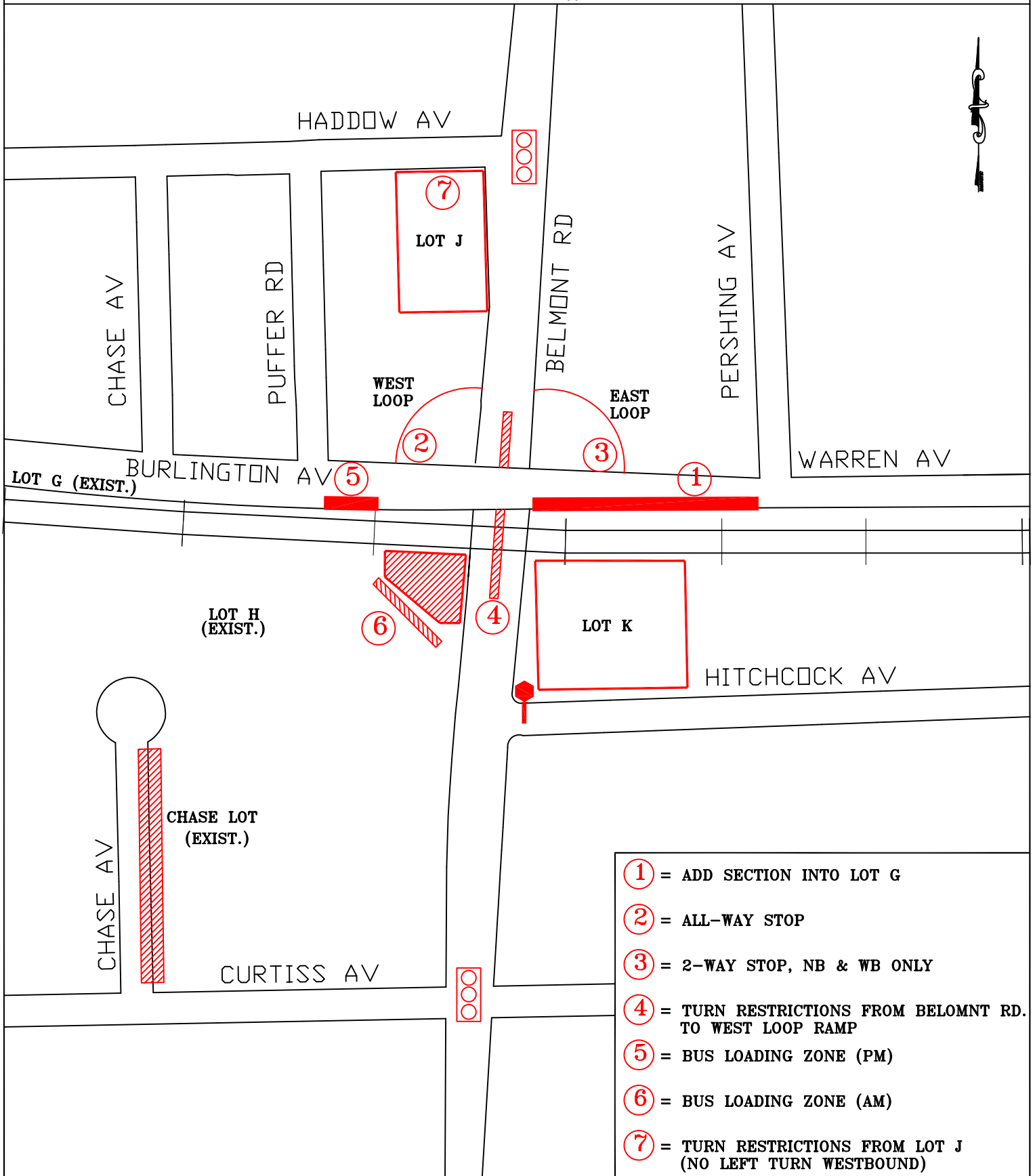

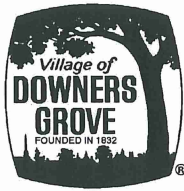

Village of Downers Grove
Public Works
Memo

To: David Fieldman, Village Manager
From: Nan Newlon, Director of Public Works
By: Dorin Fera, Traffic Manager
Date: July 24, 2012
Subject: **Request For Approval**
Temporary Suspension of Parking Regulations – Level 5 of Parking Deck

In accordance with Chapter 14-97.2 of the Downers Grove Municipal Code, a request is hereby made for the temporary suspension of parking regulations, as described below:

- Designate 40 parking spaces for Lot S permit use, along the north and east sides of Level 5
- Allow for Daily Fee parking on Level 5, beginning at 5:00 AM, except for the 40 Lot S spaces described above
- Eliminate Lot S permits through attrition and as alternate locations are identified for these permit holders

Currently, the Village's parking regulations allow daily fee parking on Level 5 only after 8:00 am, as well as 40 permit holders in Lot S who park in unmarked spaces. This after 8:00 am restriction is inconsistent with other areas of the deck and results in confusion for commuters, difficult enforcement for the Police Department, and traffic management issues in the parking deck.

Staff is requesting the removal of the current signage and suspension of the "after 8:00 am" provision for Level 5 of the Parking Deck, which is consistent with Levels 3 and 4. This action was identified by the Village's Parking Operations Group as a recommended action.

It is staff's recommendation that the most efficient and effective way to operate Level 5 of the deck is with daily fee parking and their long term recommendation is to eliminate Lot S and convert all of Level 5 to daily fee parking. To minimize impact to current the 40 current Lot S permit holders staff recommends that spaces be designated on Level 5 for Lot S and that they be eliminated over through attrition and as permits in other lots become available.

If approved staff will notify Lot S permit holders of the designated parking spaces and will monitor the impacts of the change before presenting an ordinance change to the Transportation and Parking Commission and then to Village Council. This temporary condition will remain in effect for a period not to exceed one-hundred eighty (180) days. Staff will be monitoring the performance at this location during this temporary period, and is scheduling this item for the September 12, 2012 Transportation and Parking Commission meeting.

Director of Public Works Recommendation: Nan Newlon Date: 7/24/12
 Chief of Police Concurrence: Robert A. Pentz Date: 7/24/12
 Village Manager Approval: Dorin Fera Date: 8/2/12

c: Enza Petrarca, Village Attorney
Tim Sembach, Police Department
Harry Andler, Police Department

I:\PW-Eng & Transp\Group-Traffic\Manager_Temporary Approvals\Memo_Manager Temp Approval_Lot S Level 5.doc

PARKING AND OPERATIONAL CHANGES NORTH HIGH SCHOOL TAP COMMISSION FILE #18-12

EXHIBIT 1



r.w.b.
08/29/12

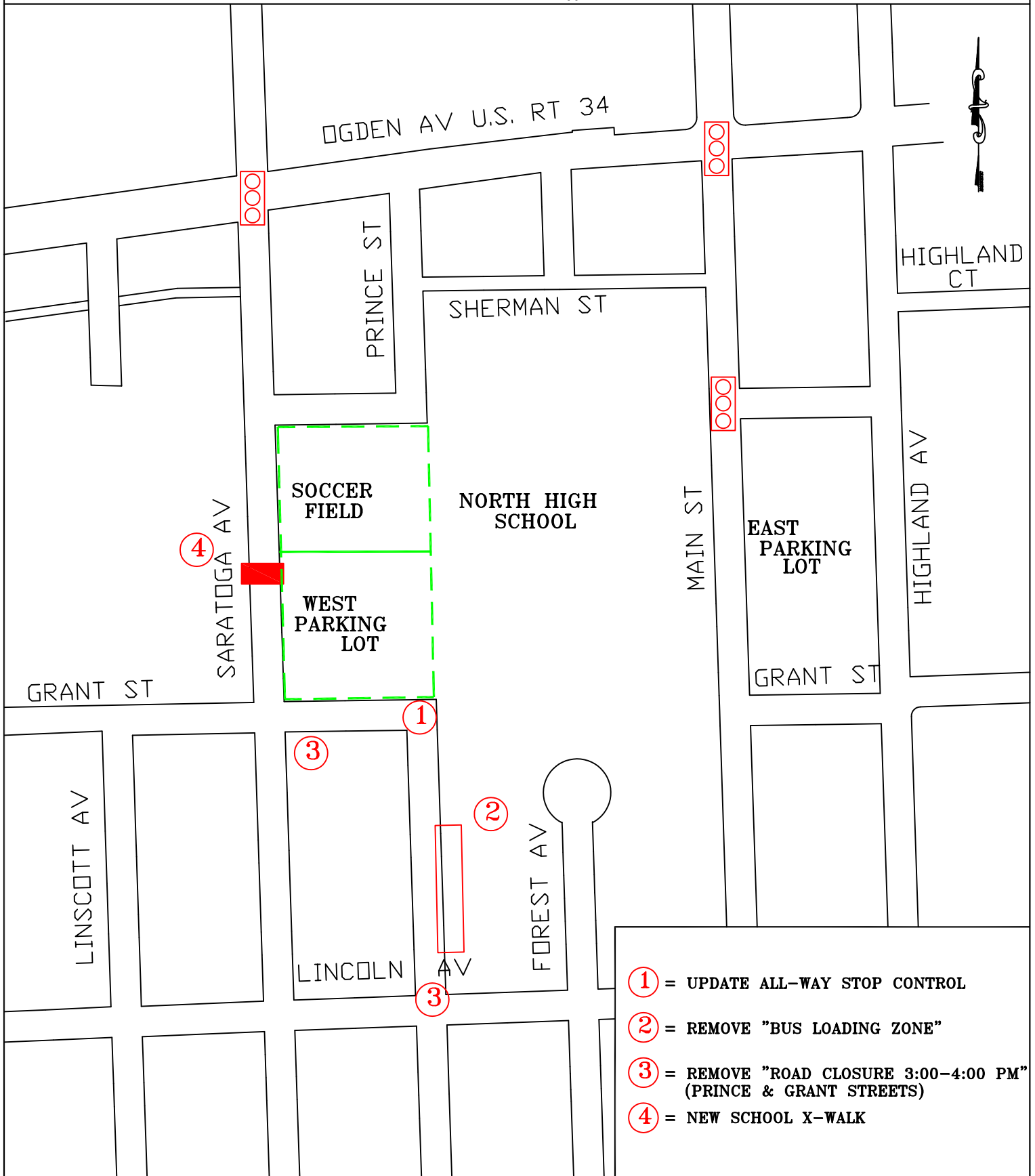

- ① = UPDATE ALL-WAY STOP CONTROL
- ② = REMOVE "BUS LOADING ZONE"
- ③ = REMOVE "ROAD CLOSURE 3:00-4:00 PM" (PRINCE & GRANT STREETS)
- ④ = NEW SCHOOL X-WALK

**TRANSPORTATION AND PARKING COMMISSION
MEETING MINUTES
September 12, 2012**

2. File # 15-12 Belmont Road – Parking and Operational Changes. Mr. Fera discussed that a number of changes were occurring with regard to this project. He referenced the changes within the document (following Exhibit 1) and was seeking approval of the changes listed. He noted many of the change were caused by the Metra/BNSF grade separation project.

Mr. Wrobel commended village staff, the railroad, and all entities involved in this project and suggested approving the request in order not to hold up the project.

Mr. Saricks asked for clarification of Exhibit 1 regarding turn restrictions and the need for a second stop sign (location No. 3), wherein **Mr. Fera** explained that due to the poor sight distance at location No. 3, when exiting, the second stop sign was necessary. Lot J off Hadow Road, because of its design only allows an exit to the east and not to the west.

MR. SARICKS MADE A MOTION THAT THE PARKING AND TRANSPORTATION COMMISSION FORWARD A POSITIVE RECOMMENDATION TO THE VILLAGE COUNCIL THAT THE FOLLOWING PROPOSED PARKING AND OPERATIONAL CHANGES, AS DESCRIBED BE IMPLEMENTED:

- **INSTALL ALL-WAY STOP CONTROL AT WARREN AVE/WEST LOOP RAMP INTERSECTION;**
- **INSTALL 2-WAY STOP CONTROL AT BURLINGTON AVE/EAST LOOP RAMP INTERSECTION, WITH EASTBOUND TRAFFIC UNCONTROLLED;**
- **INCORPORATE THE NEW ON-STREET PARKING AREA ALONG THE SOUTH SIDE OF WARREN AVENUE, BETWEEN BELMONT ROAD AND PERSHING AVENUE INTO EXISTING VILLAGE LOT G;**
- **DESIGNATE GROVE SHUTTLE PARKING ON THE SOUTH SIDE OF BURLINGTON AVENUE, IMMEDIATELY WEST OF THE WEST LOOP RAMP INTERSECTION, FOR PM PICK-UP OPERATIONS;**
- **DESIGNATE GROVE SHUTTLE PARKING ON THE SOUTHWEST SIDE OF THE TRAIN STATION, FOR AM DROP-OFF OPERATIONS;**
- **INSTALL TURN RESTRICTIONS FROM VILLAGE LOT J, PROHIBITING LEFT TURNS TO WESTBOUND HADDOW AVENUE;**
- **INSTALL TURN RESTRICTIONS FROM NORTHBOUND BELMONT ROAD ONTO WEST LOOP RAMP; AND**
- **REMOVE 12-HOUR PARKING METER ZONE ALONG SOUTH SIDE OF BURLINGTON AVE, BETWEEN WALNUT AND CHASE AVE, AND BETWEEN BELMONT ROAD TO PERSHING ROAD.**

MR. WROBEL SECONDED THE MOTION.

MOTION CARRIED UNANIMOUSLY BY VOICE VOTE OF 7-0.

3. File # 16-12 Parking Deck – Parking Revisions. Mr. Fera reported that the changes being proposed came from internal staff discussions and from recommendations from the Village's 2011 Downtown Parking Study. The largest change was the installation of the motorcycle parking in the deck. Regarding the spaces on Level 5 (Lot S) of the deck, Mr. Fera reminded commissioners that the spaces were used for commuters and during prior times for construction work, storage of vehicles, etc. However, over the years, he said users of Lot S were not renewing their permits. What started out as 100 users, are now reduced to 37 permit users. Ultimately, Mr. Fera stated the Village is proposing to make Lot S a daily fee parking space because the spaces could be filled and the village could manage the spaces easily. The other change was to open Level 5 at 5:00 a.m. like the other levels in the Deck.

Per a question, staff explained that the parking space numbers could decrease at any time and that commuters will sometimes use a different lot. But Mr. Fera also recalled that this Commission did discuss placing commuters at the Fairview lot because it was not used much. Asked why not the Belmont lot, Mr. Fera stated the Belmont lot was already filling up and the newly constructed spaces were indeed used. Mr. Fera emphasized the goal was to phase out permit parking and move the Lot S parkers to Fairview in a systematic way. Asked if it would make sense to run buses between Fairview and downtown, Mr. Fera explained the option was looked at but the issue was getting the buses to run across the tracks, plus there is a shortage of available buses for this type of service. Mr. Fera described the challenges that came with that option and the upgrades that would have to be made for the option.

A brief explanation followed on what was considered “dead” space in the parking deck. As far as a time limit on the motorcycle parking spaces in the deck, Mr. Fera stated the spaces, for now, were unlimited but were not overnight.

MR. SCHILLER MADE A MOTION THAT THE TRANSPORTATION & PARKING COMMISSION FORWARD A POSITIVE RECOMMENDATION TO THE VILLAGE COUNCIL FOR THE FOLLOWING CHANGES TO BE IMPLEMENTED:

- **REDUCE THE NUMBER OF DEDICATED LOT S PERMIT SPACES, FROM 100 TO 40 SPACES;**
- **REMOVE THE PURCHASE OF PERMIT REQUIREMENT PRIOR TO 8:00 A.M.;**
- **DESIGNATE SEVENTEEN (17) MOTORCYCLE SPACES IN DECK;**
- **CONVERT SEVEN (7) MOTORCYCLE SPACES ON FOREST AVE TO 3-HOUR SPACES;**
- **DESIGNATE DAILY FEE PARKING ON LEVEL 5, BEGINNING AT 5:00 A.M.;**
- **ELIMINATE LOT S PERMITS THROUGH ATTRITION AS ALTERNATE LOT LOCATIONS BECOME AVAILABLE.**

MR. SARICKS SECONDED THE MOTION.

MOTION CARRIED UNANIMOUSLY BY VOICE VOTE OF 7-0.

5. File # 18-12 North High School – On-Street Parking Changes. Mr. Fera explained to the commissioners that the high school was working on some changes it wanted to complete by the end of November, 2012, specifically on the Saratoga side of the football field. He updated the commissioners on those parking changes.

In reviewing the commission's recommendation for the all-way STOP sign at Prince and Grant Streets, **Mr. Fera** noted that such recommendation did not make it into the Village's ordinance, so the item was being re-introduced to be added into the ordinance. North High School stated that it had no need to close Prince and Grant Streets between 3:00 and 4:00 PM, since the bus issue was resolved. Staff agrees with this change. Regarding the change to install "No Parking, Stopping, and Standing" signs on Saratoga Avenue between Grant and Sherman, **Mr. Fera** stated this change was being introduced this year but he felt it may be revised next year after seeing this change in operation. **Mr. Fera** believed that if a driver was coming from the east there was no place to drop off a student on the west side. He will speak to the North High School leaders about this. His suggestion, rather than having a drop-off at Prince, is to consider a drop-off north along Saratoga, or possibly Sherman Avenue.

Chairman Stuebner voiced concerns about staff's signage recommendation of a No Parking or Standing sign, since there was no parking anyway due to the park district using Herrick Park for young children's soccer games which occurred after 3:30 p.m. Other ideas were suggested, but **Mr. Fera** said one problem with Saratoga Ave is that the street carries about 3,000 vehicles and can be congested during certain hours. After being informed that Herrick School soccer practices and games were after 4:00 p.m. and on Saturdays, **Mr. Fera** agreed parking on the west side of Saratoga was not an issue.

Asked if **Mr. Fera** wanted to table this matter in order to obtain more information, he believed many of the proposed operational changes around North High School were appropriate at this time. However, he suggested removing the 4th bullet point from his recommendation and voting on the remaining bullets. Commissioners then agreed to remove the 4th and 5th bullet points; staff was agreeable to that change.

MR. SCHILLER MADE A MOTION THAT THE TRAFFIC & PARKING COMMISSION FORWARD A POSITIVE RECOMMENDATION TO THE VILLAGE COUNCIL THAT THE FOLLOWING BE IMPLEMENTED:

- **UPDATE THE INTERSECTION OF PRINCE STREET AND GRANT STREET TO AN ALL-WAY STOP CONDITION;**
- **ELIMINATE THE BUS LOADING ZONE ALONG THE EAST SIDE OF PRINCE STREET, SOUTH OF GRANT STREET;**
- **ELIMINATE THE ROAD CLOSURE OF PRINCE STREET AND GRANT STREET, DURING THE 3:00 – 4:00 PM HOUR; AND**
- **DESIGNATE A NEW MID-BLOCK SCHOOL CROSSING ON SARATOGA AVENUE, NORTH OF THE WEST PARKING LOT, WITH MID-BLOCK PEDESTRIAN CROSSING IN STREET SIGNAGE.**

MR. WROBEL SECONDED THE MOTION.

MOTION CARRIED UNANIMOUSLY BY VOICE VOTE OF 7-0.